

# THE PERFECT COMPLEMENT

**The extensive range of LISTA cabinets enables you to customise and add to your workspace and storage equipment.** The high-quality steel cabinets can be easily integrated into a variety of working environments and individually adapted to your specific requirements. They are suitable both for industrial purposes and for storing files and similar items in offices and administrative departments. And of course your personal belongings are always kept safe in a LISTA cabinet.





The right solution for every need

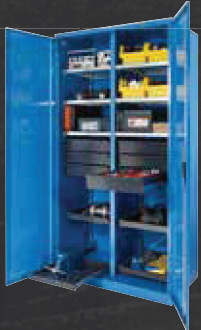

**Hinged door cabinets**  
see p. 170



**Sliding-door cabinets**  
see p. 178



**Wall-mounted cabinets with hinged or sliding doors**  
see p. 184



**Wall-mounted cabinets with roller shutter**  
see p. 186



**Roller shutter cabinets**  
see p. 188



**Vertical pull-out cabinets**  
see p. 190



**Heavy-duty cabinets**  
see p. 192



**Clothing lockers**  
see p. 196



**Compartment cabinets**  
see p. 202



**Battery charging cabinets**  
see p. 204



**Laptop cabinets and battery charging cabinets for electric scooters**  
see p. 210



**Battery charging cabinets as an e-bike charging station**  
see p. 214



**Environmental and oil cabinets**  
see p. 216

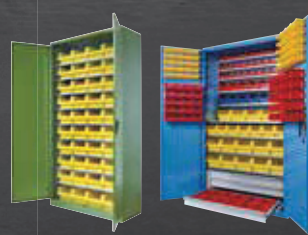

**Containers and large-scale pin cabinets\***



**Firefighter lockers\***

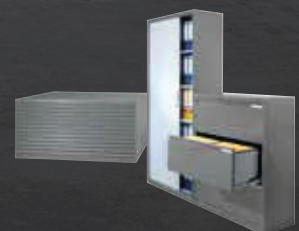

**Office cabinets\***

**LISTA hinged door cabinets provide secure and orderly storage for a variety of items.** All cabinets can be configured individually and adapted to your specific storage needs through the flexible use of partition materials and cabinet accessories.



### **ALWAYS WITH LISTA**

#### **Choice of colours**

12 standard colours, all other colours available; see p. 22









#### **Intelligent locking systems**

Replaceable cylinders which can be fitted to existing locking systems, electronic locking systems via CODE and RFID Lock for absolute security made to measure; see p. 28

#### **Individual configuration options**

in size, equipment, locking system, colour and drawer partitions; see p. 10



- 
**Utmost stability**  
 with housing load capacity of up to 500 kg
- 
**High load capacities**  
 load capacity of 60 kg or 100 kg per adjustable shelf, 60 kg per drawer/pull-out shelf
- 
**Well protected**  
 protection from dirt, liquids and physical loads thanks to closed housing with impact-resistant and abrasion-resistant surface
- 
**Flexible configuration options**  
 with covers, perforated panels, suspension folder pull-outs, desk mounts and clothes rails
- 
**Optimum order and organisation**  
 with optional installation of drawers and pull-out shelves for clear and orderly storage of small parts (for a cabinet depth of 580 mm)
- 
**Perfectly organised**  
 with viewing windows made from UV-resistant, shatterproof acrylic
- 
**Secure locking**  
 with solid sheet or viewing window doors (flush-fitting, folded from one piece) and intelligent locking systems
- 
**Can be adapted to new storage items at any time**  
 with the flexible integration and rearrangement of drawers, pull-out shelves and adjustable shelves in increments of 25 mm



# Cabinet systems | Hinged door cabinets

## Hinged door cabinets

Depending on the model, the cabinets on these two pages are equipped with: adjustable shelves, galvanised, 30 mm thick, load capacity 60 kg. Pull-out shelves and drawers, painted, anthracite grey, RAL 7016, load capacity 60 kg. **Note: Cabinets with drawers and pull-out shelves come with floor anchoring as anti-tilting device.**



Art. no. **58.658.200**  
Anthracite grey, RAL 7016  
(excluding partition material)



Art. no. **62.203.030.C**  
Reseda green, RAL 6011

**H** ↑ 1000 mm

**W** → **D** ↗ Adjustable shelves Drawers Pull-out shelves Hinge pins mounted Art. no.

### Cabinets with 1 solid sheet door

|  |     |      |   |   |   |    |       |          |                   |
|--|-----|------|---|---|---|----|-------|----------|-------------------|
|  | 500 | 400  | 1 | - | - | 60 | Hinge | KEY Lock | <b>62.150.XXX</b> |
|  | 500 | 500  | 1 | - | - | 60 | Hinge | KEY Lock | <b>62.151.XXX</b> |
|  | 500 | 580* | 1 | - | - | 60 | Hinge | KEY Lock | <b>58.280.XXX</b> |

|  |     |      |   |   |   |    |       |          |                   |
|--|-----|------|---|---|---|----|-------|----------|-------------------|
|  | 500 | 400  | 2 | - | - | 60 | Hinge | KEY Lock | <b>62.152.XXX</b> |
|  | 500 | 500  | 2 | - | - | 60 | Hinge | KEY Lock | <b>62.153.XXX</b> |
|  | 500 | 580* | 2 | - | - | 60 | Hinge | KEY Lock | <b>58.283.XXX</b> |

|  |     |      |   |      |   |       |       |          |                   |
|--|-----|------|---|------|---|-------|-------|----------|-------------------|
|  | 500 | 580* | 2 | 1×95 | - | 50/60 | Hinge | KEY Lock | <b>58.652.XXX</b> |
|--|-----|------|---|------|---|-------|-------|----------|-------------------|

### Cabinets with 2 solid sheet doors

|  |      |      |   |   |   |    |       |          |                   |
|--|------|------|---|---|---|----|-------|----------|-------------------|
|  | 1000 | 400  | 2 | - | - | 60 | Hinge | KEY Lock | <b>60.460.XXX</b> |
|  | 1000 | 500  | 2 | - | - | 60 | Hinge | KEY Lock | <b>60.461.XXX</b> |
|  | 1000 | 580* | 2 | - | - | 60 | Hinge | KEY Lock | <b>58.656.XXX</b> |

|  |      |      |   |      |   |       |       |          |                   |
|--|------|------|---|------|---|-------|-------|----------|-------------------|
|  | 1000 | 580* | 2 | 1×95 | - | 50/60 | Hinge | KEY Lock | <b>58.658.XXX</b> |
|--|------|------|---|------|---|-------|-------|----------|-------------------|



### Hinged

- for the installation of drawers and pull-out shelves, doors must be fitted with hinges
- doors are flush with the cabinet housing
- opening angle approx. 115°



### Perfect storage

All hinged door cabinet drawers can be fitted individually with LISTA partition material to ensure the correct storage of small parts within the drawers.

**H** ↑ 1950 mm

**W** → **D** ↗ Adjustable shelves Drawers Pull-out shelves Hinge pins mounted Art. no.

### Cabinets with 2 solid sheet doors

|  |     |      |   |   |   |    |       |          |                   |
|--|-----|------|---|---|---|----|-------|----------|-------------------|
|  | 750 | 500  | 4 | - | - | 60 | Hinge | KEY Lock | <b>62.155.XXX</b> |
|  | 750 | 580* | 4 | - | - | 60 | Hinge | KEY Lock | <b>62.156.XXX</b> |

**i** When ordering a cabinet from these two pages with **CODE** or **RFID Lock**, please add the suffix **"C"** or **"F"**, respectively, to the article number stated in the table (e.g. **62.201.XXX.C**).





Art. no. **58.665.010**  
Light blue, RAL 5012



**H** **1950 mm**



**W** **D** Adjustable shelves Drawers Pull-out shelves Hinge pins mounted Art. no.

**Cabinets with 2 solid sheet doors**

|      |      |   |      |   |       |       |          |                   |
|------|------|---|------|---|-------|-------|----------|-------------------|
| 1000 | 400  | 4 | -    | - | 60    | Hinge | KEY Lock | <b>60.418.XXX</b> |
| 1000 | 500  | 4 | -    | - | 60    | Hinge | KEY Lock | <b>60.419.XXX</b> |
| 1000 | 580* | 4 | -    | - | 60    | Hinge | KEY Lock | <b>58.617.XXX</b> |
| 1250 | 400  | 4 | -    | - | 60    | Hinge | KEY Lock | <b>60.420.XXX</b> |
| 1250 | 500  | 4 | -    | - | 60    | Hinge | KEY Lock | <b>60.421.XXX</b> |
| 1250 | 580* | 4 | -    | - | 60    | Hinge | KEY Lock | <b>60.471.XXX</b> |
| 1000 | 580* | 2 | 3×95 | 2 | 50/60 | Hinge | KEY Lock | <b>58.665.XXX</b> |
| 1000 | 580* | 2 | -    | 4 | 50/60 | Hinge | KEY Lock | <b>58.662.XXX</b> |

**Cabinets with 2 viewing window doors**

|      |      |   |      |   |       |       |          |                   |
|------|------|---|------|---|-------|-------|----------|-------------------|
| 1000 | 400  | 4 | -    | - | 60    | Hinge | KEY Lock | <b>62.201.XXX</b> |
| 1000 | 500  | 4 | -    | - | 60    | Hinge | KEY Lock | <b>62.202.XXX</b> |
| 1000 | 580* | 4 | -    | - | 60    | Hinge | KEY Lock | <b>60.333.XXX</b> |
| 1250 | 400  | 4 | -    | - | 60    | Hinge | KEY Lock | <b>60.583.XXX</b> |
| 1250 | 500  | 4 | -    | - | 60    | Hinge | KEY Lock | <b>60.584.XXX</b> |
| 1250 | 580* | 4 | -    | - | 60    | Hinge | KEY Lock | <b>60.585.XXX</b> |
| 1000 | 580* | 2 | 3×95 | 2 | 50/60 | Hinge | KEY Lock | <b>60.417.XXX</b> |
| 1000 | 580* | 2 | -    | 4 | 50/60 | Hinge | KEY Lock | <b>60.335.XXX</b> |

\* Retrofitting with drawers and pull-out shelves possible.



**Individual arrangements**

- with adjustable shelves, drawers and pull-out shelves
- covers, perforated panels, suspension folder pull-outs, desk mounts and clothes rails are available as optional extras



**Hinged doors with viewing windows**

- for greater transparency of stored items
- encourages order





# Cabinet systems | Hinged door cabinets



Art. no. **58.445.070**  
Ruby red, RAL 3003  
(excluding partition material)



Art. no. **60.472.050**  
Metallic grey, NCS S 6502-B

## H ↑ 1950 mm, with partition



W → D ↗ Adjustable shelves Drawers Pull-out shelves Hinge pins mounted Art. no.

### Cabinets with 2 solid sheet doors and partition

|      |      |    |      |   |       |       |          |                   |
|------|------|----|------|---|-------|-------|----------|-------------------|
| 1000 | 500  | 10 | -    | - | 60    | Hinge | KEY Lock | <b>60.614.XXX</b> |
| 1000 | 580  | 10 | -    | - | 60    | Hinge | KEY Lock | <b>60.615.XXX</b> |
| 1000 | 580* | 6  | 6×95 | 2 | 50/60 | Hinge | KEY Lock | <b>58.445.XXX</b> |



### Cabinets with 2 viewing window doors and partition

|      |      |    |      |   |       |       |          |                   |
|------|------|----|------|---|-------|-------|----------|-------------------|
| 1000 | 500  | 10 | -    | - | 60    | Hinge | KEY Lock | <b>60.621.XXX</b> |
| 1000 | 580* | 10 | -    | - | 60    | Hinge | KEY Lock | <b>60.622.XXX</b> |
| 1000 | 580* | 6  | 6×95 | 2 | 50/60 | Hinge | KEY Lock | <b>60.602.XXX</b> |

\* Retrofitting with drawers and pull-out shelves possible.



### Perfect storage

All hinged door cabinet drawers can be fitted individually with LISTA partition material to ensure the correct storage of small parts within the drawers.

## H ↑ 1950 mm, with partition and clothes storage



W → D ↗ Clothes storage equipment Hinge pins mounted Art. no.

### Cabinets with 2 solid sheet doors, partition and clothes storage

|      |     |   |    |       |          |                   |
|------|-----|---|----|-------|----------|-------------------|
| 1000 | 500 | 1 adjustable shelf usable width 982 mm, 3 adjustable shelves usable width 481 mm, 1 clothes rail with 3 plastic hooks | 60 | Hinge | KEY Lock | <b>60.472.XXX</b> |
|------|-----|---|----|-------|----------|-------------------|



### Cabinets with 2 viewing window doors, partition and clothes storage

|      |     |   |    |       |          |                   |
|------|-----|---|----|-------|----------|-------------------|
| 1000 | 500 | 1 adjustable shelf usable width 982 mm, 3 adjustable shelves usable width 481 mm, 1 clothes rail with 3 plastic hooks | 60 | Hinge | KEY Lock | <b>60.611.XXX</b> |
|------|-----|---|----|-------|----------|-------------------|

**i** When ordering a cabinet from these two pages with **CODE** or **RFID Lock**, please add the suffix **"C"** or **"F"**, respectively, to the article number stated in the table (e.g. **62.201.XXX.C**).





**Slotted adjustable shelves**  
Adjustable shelves including 4 shelf supports. Specification: steel sheet, galvanised, slotted. Long sides folded by 4 × 90°. 30 mm thick with load-bearing capacity of 60 or 100 kg.

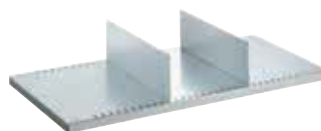

**Dividers for adjustable shelves**  
For subdividing adjustable shelves. Specification: steel sheet, painted. Colour: light grey, RAL 7035.



**Drawers and pull-out shelves**  
Full extension with ball bearings, including guide rails. Load capacity 60 kg. Specification: steel sheet. Colour: anthracite grey, RAL 7016. **Only compatible with cabinets with hinges and a depth of 580 mm.**

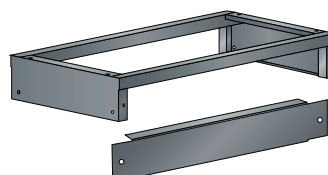

**Base**  
Robust steel tubing construction 40 × 40 mm, closed side panels, incl. fastening material (screw connection between cabinet and base). Optional: base cover to be attached as a cover on the front or rear. Colour: Anthracite grey, RAL 7016.

» Please contact us for the complete range of accessories.

|                                     |  | W → For cabinet width mm     |                  | 500               | 750               | 1000              | 1000                   | 1250               |
|-------------------------------------|--|------------------------------|------------------|-------------------|-------------------|-------------------|------------------------|--------------------|
|                                     |  | D ↗ For cabinet depth mm     |                  | Art. no.          | Art. no.          | Art. no.          | Art. no.               | Art. no.           |
| <b>Adjustable shelf</b>             |  |                              | Load capacity kg |                   |                   |                   | with central partition |                    |
| 400                                 |  | 60                           |                  | 58.100.000        | 58.103.000        | 58.106.000        | 58.100.000             | 58.109.000         |
| 400                                 |  | 100                          |                  | -                 | -                 | 60.487.000        | -                      | 60.488.000         |
| 500                                 |  | 60                           |                  | 58.101.000        | 58.104.000        | 58.107.000        | 58.101.000             | 58.110.000         |
| 500                                 |  | 100                          |                  | -                 | -                 | 60.407.000        | -                      | 60.408.000         |
| 580                                 |  | 60                           |                  | 58.102.000        | 58.105.000        | 58.108.000        | 58.102.000             | 58.111.000         |
| 580                                 |  | 100                          |                  | -                 | -                 | 60.409.000        | -                      | 60.434.000         |
|                                     |  | Usable dimensions (W × D mm) |                  | 480 × 326/426/506 | 730 × 326/426/506 | 980 × 326/426/506 | 480 × 326/426/506      | 1230 × 326/426/506 |
| <b>Divider for adjustable shelf</b> |  |                              |                  |                   |                   |                   |                        |                    |
| 400                                 |  | L 311 × H 150 mm             |                  | 58.144.000        | 58.144.000        | 58.144.000        | 58.144.000             | 58.144.000         |
| 500                                 |  | L 411 × H 150 mm             |                  | 58.145.000        | 58.145.000        | 58.145.000        | 58.145.000             | 58.145.000         |
| 580                                 |  | L 490 × H 150 mm             |                  | 58.146.000        | 58.146.000        | 58.146.000        | 58.146.000             | 58.146.000         |
| <b>Drawer</b>                       |  | H ↑ Usable height mm         |                  |                   |                   |                   |                        |                    |
| 580                                 |  | 95                           | 72               | 62.141.000        | 62.308.000        | 58.113.000        | 62.141.000             | 57.481.000         |
| 580                                 |  | 145                          | 122              | -                 | -                 | 57.471.000        | -                      | 57.482.000         |
|                                     |  | Usable dimensions (W × D mm) |                  | 357 × 459         | 617 × 459         | 867 × 459         | 357 × 459              | 1117 × 459         |
| <b>Pull-out shelf</b>               |  | H ↑ Usable height mm         |                  |                   |                   |                   |                        |                    |
| 580                                 |  | 53                           | 43               | 62.142.000        | -                 | 58.115.000        | 62.142.000             | -                  |
|                                     |  | Usable dimensions (W × D mm) |                  | 357 × 459         |                   | 867 × 459         | 357 × 459              |                    |
| <b>Base*</b>                        |  | H ↑                          |                  |                   |                   |                   |                        |                    |
| 500                                 |  | 150                          |                  | -                 | 97.844.000        | 98.518.000        | 98.518.000             | 98.253.000         |
| 580                                 |  | 150                          |                  | -                 | 98.657.000        | 98.216.000        | 98.216.000             | 97.835.000         |
| <b>Base cover, H 150 mm</b>         |  |                              |                  | -                 | 57.238.000        | 97.986.000        | 97.986.000             | 62.806.000         |

**Screw connections**

Hinged door cabinets (for housing height 1000 mm) are designed to allow a second cabinet to be screwed on (one on top of the other). **98.501.000**





# Cabinet systems | Hinged door cabinets

## Partition material sets for drawers

**W → for 500 mm**

 357 × 459 mm

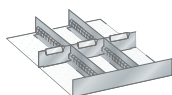

### Slotted dividers and metal separators

For front height mm      Art. no.

**95**      **62.159.000**

1 slotted partition:      21 E on one side  
2 slotted dividers:      27 E  
3 metal separators:      7 E

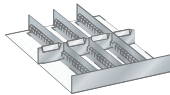

### Slotted dividers and metal separators

For front height mm      Art. no.

**95**      **62.160.000**

1 slotted partition:      21 E on one side  
3 slotted dividers:      27 E  
3 metal separators:      5 E  
1 metal separator:      6 E

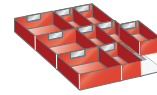

### Plastic boxes

For front height mm      Art. no.

**95**      **62.161.000**

3 plastic boxes:      150 × 150 × 71 mm  
6 plastic boxes:      150 × 75 × 71 mm  
1 spacer angle

**W → for 1000 mm**

 867 × 459 mm

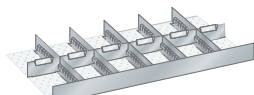

### Slotted dividers and metal separators

For front height mm      Art. no.

**95**      **58.477.000**

**145**      **61.163.000**

1 slotted partition:      51 E on one side  
5 slotted dividers:      27 E  
6 metal separators:      4 × 8 E, 1 × 9 E, 1 × 10 E

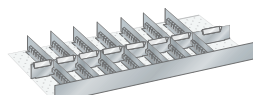

### Slotted dividers and metal separators

For front height mm      Art. no.

**95**      **58.478.000**

**145**      **61.164.000**

1 slotted partition:      51 E on one side  
7 slotted dividers:      27 E  
8 metal separators:      7 × 6 E, 1 × 9 E

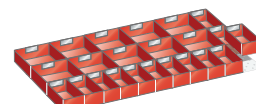

### Plastic boxes

For front height mm      Art. no.

**95**      **58.491.000**

10 plastic boxes:      150 × 150 × 71 mm  
13 plastic boxes:      150 × 75 × 71 mm  
1 spacer angle

**W → for 1250 mm**

 1117 × 459 mm

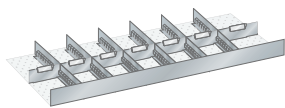

### Slotted dividers and metal separators

For front height mm      Art. no.

**95**      **61.165.000**

**145**      **61.186.000**

1 slotted partition:      65 E on one side  
6 slotted dividers:      27 E  
7 metal separators:      6 × 9 E, 1 × 10 E

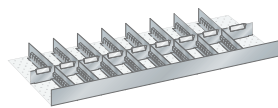

### Slotted dividers and metal separators

For front height mm      Art. no.

**95**      **61.166.000**

**145**      **61.187.000**

1 slotted partition:      65 E on one side  
8 slotted dividers:      27 E  
9 metal separators:      8 × 7 E, 1 × 9 E



Light blue, RAL 5012  
(excluding partition material)

**i** **Suitable labels for partition material**  
The practical clip-on label holders are fitted directly onto the metal separators.

**»** Labelling system see p. 268



**Note:** the front height corresponds to the drawer front height. For the actual height of the partition material see p. 262–265. Partition material sets excluding clip-on label holder.



### Cabinet housing

The housings of the hinged door cabinets are made from high-quality sheet steel and are available with specifications for one or two hinged doors, with or without a fixed partition. The inside fittings of the cabinet are easy to customize thanks to the 25:25 mm divisions.



### Hinged doors

The hinged doors in solid sheet or with a viewing window are folded from one piece, flush-fitting and flush with the cabinet housing. The doors can be equipped with hinges, with an opening angle of approx. 115°. The hinged doors can be equipped with a KEY Lock, a CODE Lock or an RFID Lock as desired.

| W → For cabinet width mm | 500 | 750 | 1000 | 1000<br>with central<br>partition | 1250 |
|--------------------------|-----|-----|------|-----------------------------------|------|
|--------------------------|-----|-----|------|-----------------------------------|------|

#### Cabinet housing

| H ↑  | Clear height | D ↗ | Art. no.          | Art. no.          | Art. no.          | Art. no.          | Art. no.          |
|------|--------------|-----|-------------------|-------------------|-------------------|-------------------|-------------------|
| 1000 | 885          | 400 | <b>57.600.XXX</b> | -                 | <b>57.612.XXX</b> | -                 | -                 |
|      |              | 500 | <b>57.601.XXX</b> | -                 | <b>57.613.XXX</b> | -                 | -                 |
|      |              | 580 | <b>57.602.XXX</b> | -                 | <b>57.614.XXX</b> | <b>58.431.XXX</b> | -                 |
| 1950 | 1835         | 400 | -                 | <b>57.609.XXX</b> | <b>57.618.XXX</b> | -                 | <b>57.627.XXX</b> |
|      |              | 500 | -                 | <b>57.693.XXX</b> | <b>57.619.XXX</b> | -                 | <b>57.628.XXX</b> |
|      |              | 580 | -                 | <b>57.611.XXX</b> | <b>57.620.XXX</b> | <b>58.433.XXX</b> | <b>57.629.XXX</b> |

#### Hinged doors excl. clasp lock

| H ↑  | Door design    | Art. no.          | Art. no.          | Art. no.          | Art. no.          | Art. no.          |
|------|----------------|-------------------|-------------------|-------------------|-------------------|-------------------|
| 1000 | Solid sheet    | <b>62.003.XXX</b> | -                 | <b>62.009.XXX</b> | <b>62.009.XXX</b> | -                 |
|      | Viewing window | <b>62.307.XXX</b> | -                 | <b>62.137.XXX</b> | <b>62.137.XXX</b> | -                 |
| 1950 | Solid sheet    | -                 | <b>62.006.XXX</b> | <b>62.011.XXX</b> | <b>62.011.XXX</b> | <b>62.016.XXX</b> |
|      | Viewing window | -                 | -                 | <b>62.012.XXX</b> | <b>62.012.XXX</b> | <b>62.017.XXX</b> |

#### + clasp lock

|                                     |                   |                   |                   |                   |                   |
|-------------------------------------|-------------------|-------------------|-------------------|-------------------|-------------------|
| <b>KEY Lock separately lockable</b> | <b>49.060.000</b> | <b>49.060.000</b> | <b>49.060.000</b> | <b>49.060.000</b> | <b>49.060.000</b> |
| <b>CODE Lock</b>                    | <b>49.085.000</b> | <b>49.085.000</b> | <b>49.085.000</b> | <b>49.085.000</b> | <b>49.085.000</b> |
| <b>RFID Lock</b>                    | <b>49.086.000</b> | <b>49.086.000</b> | <b>49.086.000</b> | <b>49.086.000</b> | <b>49.086.000</b> |



**i**

### Clasp locks

The standard KEY Lock locking system with replaceable cylinders makes it easy to adapt to existing locking systems. With CODE Lock, the key is replaced by a simple numeric combination. The LISTA RFID Lock enables automatic and contactless locking through radio frequency identification.

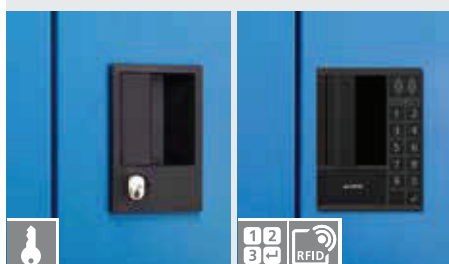



**When space is limited, sliding-door cabinets from LISTA are the ideal solution for your storage items.** Because the smooth-running doors remain in the housing and do not jut out into the traffic area.

**+ Utmost stability**  
thanks to housing with a load capacity of 500 to 950 kg  
(as from a width of 1500 mm)

**+ Perfectly smooth running**  
since the sliding doors are equipped with high-quality,  
smooth-running and quiet runners

**>> Benefits of LISTA cabinet systems**  
see p. 168





# Cabinet systems | Sliding-door cabinets with solid sheet doors



Art. no. **58.765.010**  
Light blue, RAL 5012

**H** ↑ 1000 mm

**W** → **D** ↗ Adjustable shelves Drawers Pull-out shelves **kg** **kg** Art. no.

### Cabinets with 2 solid sheet doors



|      |     |   |   |   |    |          |                   |
|------|-----|---|---|---|----|----------|-------------------|
| 1000 | 400 | 2 | - | - | 60 | KEY Lock | <b>58.747.XXX</b> |
| 1000 | 500 | 2 | - | - | 60 | KEY Lock | <b>58.756.XXX</b> |
| 1000 | 580 | 2 | - | - | 60 | KEY Lock | <b>58.757.XXX</b> |



|      |     |   |   |   |    |          |                   |
|------|-----|---|---|---|----|----------|-------------------|
| 1250 | 400 | 2 | - | - | 60 | KEY Lock | <b>58.758.XXX</b> |
| 1250 | 500 | 2 | - | - | 60 | KEY Lock | <b>58.759.XXX</b> |
| 1250 | 580 | 2 | - | - | 60 | KEY Lock | <b>58.760.XXX</b> |



Art. no. **58.757.060**  
Black, NCS S 9000-N

### Cabinets with 2 solid sheet doors and partition



|      |      |   |   |   |    |          |                   |
|------|------|---|---|---|----|----------|-------------------|
| 1500 | 400  | 4 | - | - | 60 | KEY Lock | <b>58.761.XXX</b> |
| 1500 | 500  | 4 | - | - | 60 | KEY Lock | <b>58.762.XXX</b> |
| 1500 | 580* | 4 | - | - | 60 | KEY Lock | <b>58.763.XXX</b> |



|      |      |   |      |   |       |          |                   |
|------|------|---|------|---|-------|----------|-------------------|
| 2000 | 400  | 4 | -    | - | 60    | KEY Lock | <b>58.796.XXX</b> |
| 2000 | 500  | 4 | -    | - | 60    | KEY Lock | <b>58.764.XXX</b> |
| 2000 | 580* | 4 | -    | - | 60    | KEY Lock | <b>58.765.XXX</b> |
| 2000 | 580* | 2 | 2×95 | 4 | 50/60 | KEY Lock | <b>58.745.XXX</b> |



### Sliding-door cabinets

Depending on the model, the cabinets on these two pages are fitted with: adjustable shelves, galvanised, 30 mm thick, load capacity 60 kg, pull-out shelves and drawers, painted, anthracite grey, RAL 7016, load capacity 50 kg



H ↑ 1950 mm

Art. no. **58.750.020**  
Light grey, RAL 7035

Adjustable shelves    Drawers    Pull-out shelves          Art. no.

**Cabinets with 2 solid sheet doors**

|      |     |   |   |   |    |          |                   |
|------|-----|---|---|---|----|----------|-------------------|
| 1000 | 400 | 4 | - | - | 60 | KEY Lock | <b>58.748.XXX</b> |
| 1000 | 500 | 4 | - | - | 60 | KEY Lock | <b>58.749.XXX</b> |
| 1000 | 580 | 4 | - | - | 60 | KEY Lock | <b>58.750.XXX</b> |

|      |     |   |   |   |    |          |                   |
|------|-----|---|---|---|----|----------|-------------------|
| 1250 | 400 | 4 | - | - | 60 | KEY Lock | <b>58.777.XXX</b> |
| 1250 | 500 | 4 | - | - | 60 | KEY Lock | <b>58.778.XXX</b> |
| 1250 | 580 | 4 | - | - | 60 | KEY Lock | <b>58.779.XXX</b> |

**Cabinets with 2 solid sheet doors and partition**

|      |      |   |   |   |       |          |                   |
|------|------|---|---|---|-------|----------|-------------------|
| 1000 | 580* | 8 | - | - | 60    | KEY Lock | <b>58.751.XXX</b> |
| 1500 | 400  | 8 | - | - | 60    | KEY Lock | <b>58.780.XXX</b> |
| 1500 | 500  | 8 | - | - | 60    | KEY Lock | <b>58.781.XXX</b> |
| 1500 | 580* | 8 | - | - | 60    | KEY Lock | <b>58.782.XXX</b> |
| 2000 | 400  | 8 | - | - | 60    | KEY Lock | <b>58.783.XXX</b> |
| 2000 | 500  | 8 | - | - | 60    | KEY Lock | <b>58.784.XXX</b> |
| 2000 | 580* | 8 | - | - | 60    | KEY Lock | <b>58.754.XXX</b> |
| 2000 | 580* | 4 | - | 4 | 50/60 | KEY Lock | <b>58.755.XXX</b> |



**Lock-down cylinder lock / KEY Lock**

The doors cannot be prised out thanks to the right-angled bar used in the locking system.



**Extremely smooth running**

The ball bearing rollers of the sliding doors run quietly on the guide rails.



# Cabinet systems | Sliding-door cabinets with viewing window doors



Art. no. **60.720.070**  
Ruby red, RAL 3003

**H** ↑ 1000 mm

**W** → **D** ↗ Adjustable shelves Drawers Pull-out shelves Art. no.

### Cabinets with 2 viewing window doors and partition

|      |      |   |   |   |    |          |                   |
|------|------|---|---|---|----|----------|-------------------|
| 1500 | 400  | 4 | - | - | 60 | KEY Lock | <b>60.715.XXX</b> |
| 1500 | 500  | 4 | - | - | 60 | KEY Lock | <b>60.716.XXX</b> |
| 1500 | 580* | 4 | - | - | 60 | KEY Lock | <b>60.717.XXX</b> |

|      |      |   |        |   |       |          |                   |
|------|------|---|--------|---|-------|----------|-------------------|
| 2000 | 400  | 4 | -      | - | 60    | KEY Lock | <b>60.721.XXX</b> |
| 2000 | 500  | 4 | -      | - | 60    | KEY Lock | <b>60.722.XXX</b> |
| 2000 | 580* | 4 | -      | - | 60    | KEY Lock | <b>60.723.XXX</b> |
| 2000 | 580* | 2 | 2 × 95 | 4 | 50/60 | KEY Lock | <b>60.725.XXX</b> |



### Sliding doors with viewing windows

The UV-resistant acrylic glass is shatterproof and enables clear organisation at the workstation.

**H** ↑ 1950 mm

**W** → **D** ↗ Adjustable shelves Drawers Pull-out shelves Art. no.

### Cabinets with 2 viewing window doors and partition

|      |     |   |   |   |    |          |                   |
|------|-----|---|---|---|----|----------|-------------------|
| 1500 | 400 | 8 | - | - | 60 | KEY Lock | <b>60.718.XXX</b> |
| 1500 | 500 | 8 | - | - | 60 | KEY Lock | <b>60.719.XXX</b> |
| 1500 | 580 | 8 | - | - | 60 | KEY Lock | <b>60.720.XXX</b> |

|      |      |   |   |   |       |          |                   |
|------|------|---|---|---|-------|----------|-------------------|
| 2000 | 400  | 8 | - | - | 60    | KEY Lock | <b>60.726.XXX</b> |
| 2000 | 500  | 8 | - | - | 60    | KEY Lock | <b>60.727.XXX</b> |
| 2000 | 580* | 8 | - | - | 60    | KEY Lock | <b>60.728.XXX</b> |
| 2000 | 580* | 4 | - | 4 | 50/60 | KEY Lock | <b>60.729.XXX</b> |



### Sliding-door cabinets

Depending on the model, the cabinets on these two pages are fitted with: adjustable shelves, galvanised, 30 mm thick, load capacity 60 kg, pull-out shelves and drawers, painted, anthracite grey, RAL 7016, load capacity 50 kg





**Slotted adjustable shelves**  
Adjustable shelves including 4 shelf supports. Specification: steel sheet, galvanised, slotted. Long sides folded by 4 × 90°. 30 mm thick with load-bearing capacity of 60 or 100 kg.

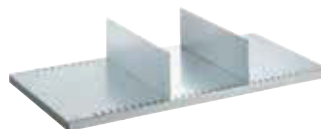

**Dividers for adjustable shelves**  
For subdividing adjustable shelves. Specification: steel sheet, painted. Colour: light grey, RAL 7035.



**Drawers and pull-out shelves**  
Full extension with ball bearings, including guide rails. Load capacity 50 kg. Specification: steel sheet. Colour: anthracite grey, RAL 7016. **For cabinet depth 580 mm.**

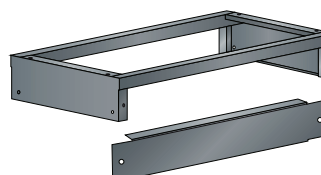

**Base**  
Robust steel tubing construction 40 × 40 mm, closed side panels, incl. fastening material (screw connection between cabinet and base). Optional: base cover to be attached as a cover on the front or rear. Colour: Anthracite grey, RAL 7016.

|                                     |                             | <b>W</b> → For cabinet width mm |                   | 1000               | 1000                   | 1250              | 1500                   | 2000                   |
|-------------------------------------|-----------------------------|---------------------------------|-------------------|--------------------|------------------------|-------------------|------------------------|------------------------|
|                                     |                             |                                 |                   |                    | with central partition |                   | with central partition | with central partition |
| <b>D</b> ↗ For cabinet depth mm     | Load capacity kg            | Art. no.                        | Art. no.          | Art. no.           | Art. no.               | Art. no.          | Art. no.               | Art. no.               |
| <b>Adjustable shelf</b>             |                             |                                 |                   |                    |                        |                   |                        |                        |
| 400                                 | 60                          | 58.106.000                      | 58.100.000        | 58.109.000         | 58.103.000             | 58.106.000        |                        |                        |
| 400                                 | 100                         | 60.487.000                      | -                 | 60.488.000         | -                      | 60.487.000        |                        |                        |
| 500                                 | 60                          | 58.107.000                      | 58.101.000        | 58.110.000         | 58.104.000             | 58.107.000        |                        |                        |
| 500                                 | 100                         | 60.407.000                      | -                 | 60.408.000         | -                      | 60.407.000        |                        |                        |
| 580                                 | 60                          | 58.108.000                      | 58.102.000        | 58.111.000         | 58.105.000             | 58.108.000        |                        |                        |
| 580                                 | 100                         | 60.409.000                      | -                 | 60.434.000         | -                      | 60.409.000        |                        |                        |
| Usable dimensions (W × D mm)        |                             | 980 × 326/426/506               | 480 × 326/426/506 | 1230 × 326/426/506 | 730 × 326/426/506      | 980 × 326/426/506 |                        |                        |
| <b>Divider for adjustable shelf</b> |                             |                                 |                   |                    |                        |                   |                        |                        |
| 400                                 | L 311 × H 150 mm            | 58.144.000                      | 58.144.000        | 58.144.000         | 58.144.000             | 58.144.000        |                        |                        |
| 500                                 | L 411 × H 150 mm            | 58.145.000                      | 58.145.000        | 58.145.000         | 58.145.000             | 58.145.000        |                        |                        |
| 580                                 | L 490 × H 150 mm            | 58.146.000                      | 58.146.000        | 58.146.000         | 58.146.000             | 58.146.000        |                        |                        |
| <b>Drawer</b>                       |                             |                                 |                   |                    |                        |                   |                        |                        |
|                                     | <b>H</b> ↑ Usable height mm |                                 |                   |                    |                        |                   |                        |                        |
| 580                                 | 95                          | 72                              | 58.113.000        | 62.141.000         | -                      | 62.308.000        | 58.113.000             |                        |
| 580                                 | 145                         | 122                             | 57.471.000        | -                  | -                      | -                 | 57.471.000             |                        |
| Usable dimensions (W × D mm)        |                             |                                 | 867 × 459         | 357 × 459          |                        | 617 × 459         | 867 × 459              |                        |
| <b>Pull-out shelf</b>               |                             |                                 |                   |                    |                        |                   |                        |                        |
|                                     | <b>H</b> ↑ Usable height mm |                                 |                   |                    |                        |                   |                        |                        |
| 580                                 | 53                          | 43                              | 58.115.000        | 62.142.000         | -                      | -                 | 58.115.000             |                        |
| Usable dimensions (W × D mm)        |                             |                                 | 867 × 459         | 357 × 459          |                        |                   | 867 × 459              |                        |
| <b>Base</b>                         |                             |                                 |                   |                    |                        |                   |                        |                        |
|                                     | <b>H</b> ↑                  |                                 |                   |                    |                        |                   |                        |                        |
| 500                                 | 150                         |                                 | 98.518.000        | 98.518.000         | 98.253.000             | 57.277.000        | 97.103.000             |                        |
| 580                                 | 150                         |                                 | 98.216.000        | 98.216.000         | 97.835.000             | 97.457.000        | 97.133.000             |                        |
| <b>Base cover, H 150 mm</b>         |                             |                                 | 97.986.000        | 97.986.000         | 62.806.000             | 57.239.000        | 98.259.000             |                        |

» Partition material see p. 176

» Please contact us for the complete range of accessories.

\* Floor anchoring may be required, depending on the version.



## Cabinet systems | Wall-mounted cabinets with hinged or sliding doors



**+ Utmost stability**  
thanks to housing with load capacity of 40 to 80 kg

**+ Optimum order and organisation**  
thanks to adjustable shelves with load capacities of up to 40 kg for neat and tidy storage of tools, files and other equipment

**+ User-friendly**  
since the stored items are easy to reach and at viewing height

**+ Perfect cable management**  
with cable openings and intermediate shelf for tidy and well-protected cable routing

**+ Flexible configuration options**  
thanks to pre-perforated holes (punch-outs) as cable guide for power strips and LED lights

**>> Benefits of LISTA cabinet systems**  
see p. 168

**LISTA wall-mounted cabinets are perfect as additional storage space for small parts, documents and more.** They keep your storage items ergonomically and conveniently stored at viewing height. Just mount them on the wall and in no time everything is just where it should be: neatly put away.





Art. no. **69.861.200**  
Wall-mounted cabinets with sliding doors,  
height 420 mm, RAL 7016



Art. no. **69.865.200**  
Wall-mounted cabinets with sliding doors,  
height 800 mm, RAL 7016

### Wall-mounted cabinets

Flush-fitting hinged doors with reinforced edges for increased rigidity, with fulcrum pins, 110 ° opening angle. Sliding doors edged from one piece, low-noise ball-bearing-mounted sliding door guide. Housing incl. punch-outs for power supply to the cabinets. Adjustable shelving (adjustable grid 25 mm) cable compartments under each shelf are optionally available. Base height: 35 mm.

**H** **420 mm** Clear height 350 mm



|             |            | Specification                            |           | Door storage/<br>door guide |          | Art. no.          |
|-------------|------------|--|-----------|-----------------------------|----------|-------------------|
| <b>1000</b> | <b>350</b> | Punch-outs<br>Optional: Adjustable shelf | <b>40</b> | pin hinge                   | KEY Lock | <b>69.860.XXX</b> |



| <b>1000</b> | <b>350</b> | Punch-outs<br>Optional: Adjustable shelf | <b>40</b> | ball bearing | KEY Lock | <b>69.861.XXX</b> |
|-------------|------------|--|-----------|--------------|----------|-------------------|
|-------------|------------|--|-----------|--------------|----------|-------------------|

**H** **800 mm** Clear height 730 mm



|             |            | Specification                    |              | Door storage/<br>door guide |          | Art. no.          |
|-------------|------------|----------------------------------|--------------|-----------------------------|----------|-------------------|
| <b>1000</b> | <b>350</b> | Punch-outs<br>1 adjustable shelf | <b>40/80</b> | pin hinge                   | KEY Lock | <b>69.865.XXX</b> |



| <b>1000</b> | <b>350</b> | Punch-outs<br>1 adjustable shelf | <b>40/80</b> | ball bearing | KEY Lock | <b>69.866.XXX</b> |
|-------------|------------|----------------------------------|--------------|--------------|----------|-------------------|
|-------------|------------|----------------------------------|--------------|--------------|----------|-------------------|

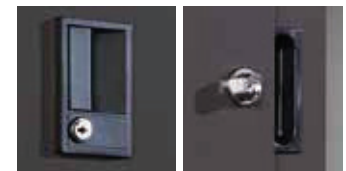

#### Clasp lock KEY Lock

- standard locking system for hinged doors with replaceable cylinders
- makes it easy to adapt to existing locking systems

#### Lock-down cylinder lock / KEY Lock

- locking system for sliding doors
- cannot be prised out thanks to the right-angled bar



#### Extremely smooth running

- the ball bearing rollers of the sliding doors run quietly on the guide rails



#### Cable feed-through

- punch-outs allow the cabinet to be provided with a power supply, see p. 147
- punch-outs are present on the lid and base
- there is space for cable routing underneath the shelf



#### Adjustable shelf for wall-mounted cabinet

Width: 1000 mm.  
Load capacity: 40 kg.

Art. no. **69.883.XXX**



#### Cover flap set

Custom-fit flap and cable collar for punch-outs.  
Delivery: 2 hinged flaps.  
1 cable collar

Art. no. **69.869.000**







### Flexible configuration and organisation

thanks to perforated and slotted rear panels, individually configurable with optional adjustable shelves or integrated cable conduit



### User-friendly operation

Aluminium roller shutters with spring-loaded coils: self-locking, effortless operation. Optimum use of space with a continuous usable depth of 215 mm



### Versatile

also available as top-mounted cabinet without a base for direct mounting onto the worktop, see p. 121



### Benefits of LISTA cabinet systems

see p. 168

**LISTA wall-mounted shutter cabinet for optimal tool storage.** The cabinet can be custom-adapted to your needs with optional accessories such as an adjustable shelf or power conduit.

### Wall-mounted cabinet with aluminium roller shutters

This type of cabinet is ideal for securely hanging tools. The space-saving roller shutter winder gives a maximum usable depth of 215 mm and also allows the use of standard folders. In addition, this cabinet can optionally be equipped with an integrated cable conduit to accommodate the energy modules (see p. 145). For direct fastening to the work-top, this cabinet (1050 mm high) can also be ordered without a floor (see p. 121).



Art. no. **69.851.200**  
Wall-mounted cabinet with aluminium roller shutters, RAL 7016

### Roller shutter cabinet

Aluminium roller shutter with spring-loaded winding ensures a large usable depth (215 mm) and safe operation (self-locking). The sturdy steel housing and the aluminium roller shutters ensure stable, secure storage. Punch-outs intended for power supply. Perforated rear panel for using perforated wall hooks (see p. 163), with square perforation 10 × 10 and 38 mm divisions.

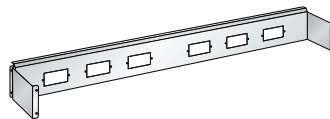
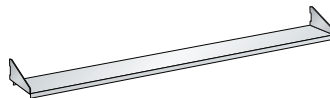
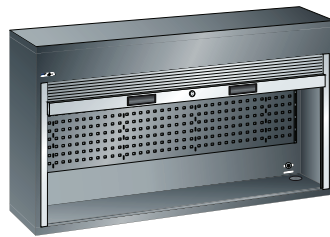

| Model      | Fastening                                   | W →  | D ↗ | H ↑ | Art. no.          |
|------------|---|------|-----|-----|-------------------|
| with floor | on support pillar via perforated rear panel | 1500 | 250 | 800 | <b>69.850.XXX</b> |
| with floor | on support pillar via perforated rear panel | 2000 | 250 | 800 | <b>69.851.XXX</b> |

|                         | W →  | D ↗ | kg | Art. no.          |
|-------------------------|------|-----|----|-------------------|
| <b>Adjustable shelf</b> | 1500 | 175 | 20 | <b>69.854.XXX</b> |
| optional                | 2000 | 175 | 20 | <b>69.855.XXX</b> |

|  | for W → | for power modules | Art. no.          |
|--|---------|-------------------|-------------------|
| <b>Power conduit set</b>   | 1500    | 6 ×               | <b>89.022.XXX</b> |
| Integrated cable conduit solution. Designed for installation in roller shutter cabinet. The power conduit can be equipped with the power modules. see page 145 | 2000    | 8 ×               | <b>89.023.XXX</b> |



#### Housing

- Sturdy steel structure
- Version with shelf as an overhead cabinet or alternatively without a shelf as a top-mounted cabinet, see p. 121



#### Handle

- Integrated handle
- Locking mechanism has no impact on usable depth
- Locking with KEY lock, keyed alike option also possible on request

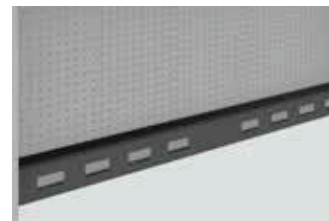

#### Power conduit

- Optionally integrated power conduit
- Configurable with power modules (see page 144)

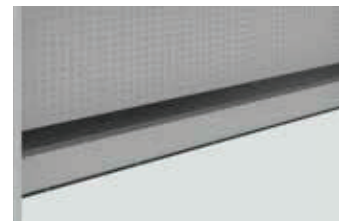

#### Adjustable shelf

- Optional adjustable shelf
- Adjustment increment: 25 mm



## Cabinet systems | Roller shutter cabinets

**LISTA roller shutter cabinets give you full access to your stored items even in confined spaces.** And the individual configuration and equipment options mean that they are right for a wide variety of workplaces from workshop to office.

### + Utmost stability

with housing load capacity of up to 500 kg

### + Secure locking

thanks to the smooth-running roller shutters with user-friendly push handle and integrated cylinder lock with replaceable cylinders (other locking systems on request)

### + User-friendly

roller shutter stops at any height without the need for catches

### >> Benefits of LISTA cabinet systems

see p. 168





**Roller shutter cabinets**

Depending on the model, the cabinets on this page are fitted with: adjustable shelves, galvanised, 30 mm thick, load capacity 60 or 100 kg, pull-out shelves and drawers, painted, anthracite grey, RAL 7016, load capacity 50 kg, roller shutter in PVC, colour similar to light grey, RAL 7035

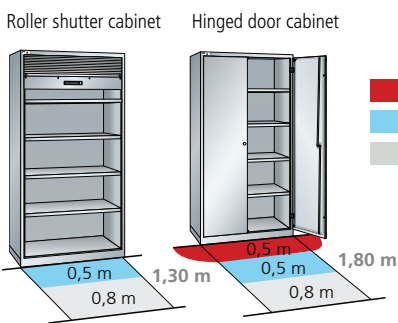

Art. no. **58.401.010**  
Light blue, RAL 5012



**Direct access to all stored items**

The smooth-running roller shutter which can be operated with one hand stops at any height without the need for catches.



**Strike plate**

The sturdy metal strike plate comes with an anti-trap finger guard for safety reasons.



**Push handle cylinder lock/ KEY Lock**

The replaceable cylinder makes it possible to adapt the locking system as required.



| H ↑ 1950 mm        |         | W → 1000 mm      |       | D ↗ 580 mm* |                   |
|--------------------|---------|------------------|-------|-------------|-------------------|
| Adjustable shelves | Drawers | Pull-out shelves |       |             | Art. no.          |
| 4                  | -       | -                | 60    | KEY Lock    | <b>58.401.XXX</b> |
| 2                  | -       | 2                | 50/60 | KEY Lock    | <b>58.402.XXX</b> |
| 2                  | 1 × 95  | 2                | 50/60 | KEY Lock    | <b>58.404.XXX</b> |
| 2                  | -       | 4                | 50/60 | KEY Lock    | <b>58.403.XXX</b> |
| 2                  | 2 × 95  | 3                | 50/60 | KEY Lock    | <b>58.406.XXX</b> |
| 2                  | 1 × 95  | 4                | 50/60 | KEY Lock    | <b>58.405.XXX</b> |

\* Retrofitting with drawers and pull-out shelves possible.

**Slotted adjustable shelves**

Adjustable shelves including 4 shelf supports. Specification: steel sheet, galvanised, slotted. Long sides folded by 4 × 90°. 30 mm thick with load-bearing capacity of 60 or 100 kg.

| For cabinet depth mm         | Load capacity kg | Art. no.          |
|------------------------------|------------------|-------------------|
| <b>Adjustable shelf</b>      |                  |                   |
| <b>580</b>                   | 60               | <b>58.108.000</b> |
| <b>580</b>                   | 100              | <b>60.409.000</b> |
| Usable dimensions (W × D mm) |                  | 980 × 506         |

**Dividers for adjustable shelves**

For subdividing adjustable shelves. Specification: steel sheet, painted. Colour: light grey, RAL 7035.

| <b>Divider for adjustable shelf</b> | L 490 × H 150 mm | Art. no.          |
|-------------------------------------|------------------|-------------------|
| <b>580</b>                          |                  | <b>58.146.000</b> |

**Drawers and pull-out shelves**

Full extension with ball bearings, including guide rails. Load capacity 50 kg. Specification: steel sheet. Colour: anthracite grey, RAL 7016.

| <b>Drawer</b>                |     | Usable height mm | Art. no.          |
|------------------------------|-----|------------------|-------------------|
| <b>580</b>                   | 95  | 72               | <b>58.113.000</b> |
| <b>580</b>                   | 145 | 122              | <b>57.471.000</b> |
| Usable dimensions (W × D mm) |     | 867 × 459        |                   |

| <b>Pull-out shelf</b>        |    | Usable height mm | Art. no.          |
|------------------------------|----|------------------|-------------------|
| <b>580</b>                   | 53 | 43               | <b>58.115.000</b> |
| Usable dimensions (W × D mm) |    | 867 × 459        |                   |

**Base**

Robust steel tubing construction 40 × 40 mm, closed side panels, incl. fastening material (screw connection between cabinet and base). Optional: base cover to be attached as a cover on the front or rear. Colour: Anthracite grey, RAL 7016.

| <b>Base</b>                 |     | Art. no.          |
|-----------------------------|-----|-------------------|
| <b>580</b>                  | 150 | <b>98.216.000</b> |
| <b>Base cover, H 150 mm</b> |     | <b>97.986.000</b> |

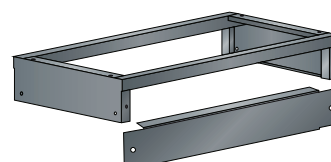
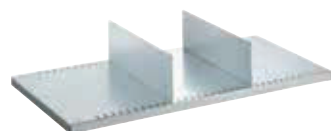

Partition material see p. 176



# Cabinet systems | Vertical pull-out cabinets

- + Utmost stability**  
with a housing load capacity of up to 1000 kg
- + High load capacities**  
vertical pull-outs with a load capacity of up to 200 kg
- + Perfectly smooth running**  
can be fully extended on smooth-running plastic runners even with heavy weights off-floor
- + Outstanding safety features**  
through standard single-drawer blocking system
- + Secure locking**  
thanks to front covers or hinged doors with KEY Lock including replaceable cylinders (other locking systems are available on request)
- + Flexible configuration options**  
with adjustable shelves, perforated panels and shelves for tool holders for NC storage in increments of 50 mm
- + User-friendly**  
with direct access to tools and small parts from both sides
- + Well protected**  
protection from dirt, liquids and physical loads thanks to closed housing with impact-resistant and abrasion-resistant surface



**Vertical pull-out cabinets from LISTA provide space-saving storage for tools, supplies and more where space is at a premium.** The pull-outs can be used from both sides and can optionally be fitted with perforated panels or shelves to hold plastic containers, tools, documents and LISTA tool holders for NC storage. The result: maximum storage space with a very small footprint. That's what we call efficient.



Art. no. **85.799.010**  
Fronts light blue, RAL 5012  
(excluding storage containers)

**Vertical pull-out cabinets**

Depending on the model, all cabinets on this page are equipped with: front covers 3 × W 307 mm, 4 × W 230 mm, pull-outs with a load capacity of 200 kg, perforated panels with square holes 10 × 10 mm, 38 mm apart



Art. no. **85.789.050**  
Doors metallic grey, NCS S 6502-B  
(excluding tools)

**H** ↑ 1950 mm    **W** → 1000 mm    **D** ↗ 695 mm



Specification

**Cabinet with front covers for NC storage**

3 or 4 pull-outs with 4 adjustable shelves each for LISTA NC tool holder (see p. 102), usable dimensions: W 118 × D 554 mm, accommodation length for NC tool holder = 554 mm

| Pull-outs | kg  | Lock     | Art. no.          |
|-----------|-----|----------|-------------------|
| 3         | 200 | KEY Lock | <b>82.979.XXX</b> |
| 4         | 200 | KEY Lock | <b>82.980.XXX</b> |



**Cabinet with front covers and adjustable shelves**

3 or 4 pull-outs with 4 adjustable shelves each, plain, usable dimensions: W 291/210 × D 584 × H 25 mm

|   |     |          |                   |
|---|-----|----------|-------------------|
| 3 | 200 | KEY Lock | <b>85.792.XXX</b> |
| 4 | 200 | KEY Lock | <b>85.799.XXX</b> |



**Cabinet with front covers and perforated panels**

3 or 4 pull-outs with perforated panels, H 1700 × D 612 mm, can be used on both sides

|   |     |          |                   |
|---|-----|----------|-------------------|
| 3 | 200 | KEY Lock | <b>85.798.XXX</b> |
| 4 | 200 | KEY Lock | <b>85.791.XXX</b> |

**H** ↑ 1950 mm    **W** → 1000 mm    **D** ↗ 600 mm



Specification

**Cabinet with 2 hinged doors and perforated panels**

3 or 4 pull-outs with perforated panels, H 1700 × D 560 mm, can be used on both sides, door fitted with hinges, opening angle 115°

| Pull-outs | kg  | Lock     | Art. no.          |
|-----------|-----|----------|-------------------|
| 3         | 200 | KEY Lock | <b>85.789.XXX</b> |
| 4         | 200 | KEY Lock | <b>85.788.XXX</b> |



**Adjustable shelves**

The adjustable shelves in two available widths provide optimum storage space for stored items.



**NC storage**

Safe and space-saving storage of tools in the vertical pull-outs in exchangeable frames.



**Perforated panels**

Pull-out perforated panels enable flexible attachment of stored items thanks to a wide range of hooks.

» For NC tool holders and partitioning schemes see p. 101

» For pegboard hooks, plastic storage containers see p. 162

200 kg per pull-out



**LISTA heavy-duty cabinets are perfect for storing heavy materials on adjustable shelves, pull-out shelves and in drawers.** Additionally, all common access protection solutions, from retracting doors and hinged doors to vertical roller shutters, can be used. For greater transparency of stored items, doors can be supplied with viewing windows on request.



- + Utmost stability**  
with a housing load capacity of up to 1500 kg
- + High load capacities**  
160 kg per adjustable shelf, 200 kg per drawer/  
pull-out shelf
- + Outstanding safety features** – with single  
drawer blocking mechanism for heavy-duty cabinets with  
retracting doors to prevent the cabinet from tipping over
- + User-friendly**  
because of the fast access to all stored items –  
retracting doors or smooth-running roller shutters with  
user-friendly push handle
- + Secure locking**  
with retracting doors, hinged doors or roller shutter  
and intelligent locking systems like CODE/RFID Lock
- + Well protected**  
protection from dirt, liquids and physical loads thanks  
to closed housing with impact-resistant and abrasion-  
resistant surface
- + Perfectly organised**  
with viewing windows made from UV-resistant,  
shatterproof acrylic
- + Can be adapted to new storage items at any time**  
with the flexible integration and rearrangement of drawers,  
pull-out shelves and adjustable shelves in increments of 25 mm
- >> Fully compatible with LISTA drawer cabinets  
and drawer storage walls because of the  
standardised unit of measure**  
see p. 38 and/or 84



Art. no. **59.542.010**  
Light blue, RAL 5012

Art. no. **59.543.070**  
Ruby red, RAL 3003  
(excluding partition material)

**Heavy-duty cabinets with retracting doors**

The cabinets are equipped with: adjustable shelves, galvanised, 33 mm thick, pull-out shelves and drawers, painted, generally grey, NCS 4502-B. Retracting doors folded from one piece, optionally either in solid sheet steel or with viewing windows. Fitted in hinge brackets, retracting range 90°, projection of doors when opened is 85 mm. Anti-tilting is ensured by the single-drawer blocking system. Available with KEY Lock, CODE Lock or RFID Lock locking systems.

**54 × 27 E**    **H** ↑ **1950 mm**    **W** → **1146 mm**    **D** ↗ **690 mm**



Drawers    Adjustable shelves    Pull-out shelves       Hinge pins mounted       Art. no.

**Cabinets with 2 solid sheet retracting doors**

|                  |   |   |         |               |          |                   |
|------------------|---|---|---------|---------------|----------|-------------------|
| -                | 4 | - | 160     | Hinge bracket | KEY Lock | <b>59.541.XXX</b> |
| 2 × 75 / 1 × 150 | 2 | 2 | 160/200 | Hinge bracket | KEY Lock | <b>59.543.XXX</b> |

**Cabinets with 2 viewing window retracting doors**

|                  |   |   |         |               |          |                   |
|------------------|---|---|---------|---------------|----------|-------------------|
| -                | 4 | - | 160     | Hinge bracket | KEY Lock | <b>59.540.XXX</b> |
| 2 × 75 / 1 × 150 | 2 | 2 | 160/200 | Hinge bracket | KEY Lock | <b>59.542.XXX</b> |



**Retracting doors**

- disappear in the housing when opened in order to give the best possible access (doors only project by 85 mm)
- folded from a single piece
- either made of full sheet steel or equipped with viewing windows
- fitted into hinge brackets, retracting range 90°
- KEY Lock, CODE Lock or RFID Lock locking systems



- fully extendable
- load capacity up to 200 kg



**Robust housing**

- welded sheet steel construction with integrated support pillar system



**i** When ordering a cabinet from these two pages with **CODE** or **RFID Lock** locking system, please add the suffix **"C"** or **"F"** to the article number given in the table (e.g. **98.081.XXX.C**).



» For partition material see p. 248

» For LISTA Script labelling system see p. 268





# Cabinet systems | preconfigured heavy-duty cabinets



Art. no. **98.091.100**  
Signal blue, RAL 5005



Art. no. **98.086.050**  
Metallic grey, NCS S 6502-B

## Heavy-duty cabinets with hinged doors

The cabinets are equipped with: adjustable shelves, galvanised, 35 mm thick, pull-out shelves and drawers, painted, generally grey, NCS 4502-B. Hinged doors folded from one piece, optionally either in solid sheet steel or with viewing windows. KEY, CODE or RFID Locks available.



**54 × 27 E**      **H** ↑ 1950 mm      **W** → 1100 mm      **D** ↗ 641 mm



| Drawers   | Adjustable shelves | Pull-out shelves | kg      | Hinge pins mounted |          | Art. no.          |
|---|--------------------|------------------|---------|--------------------|----------|-------------------|
| <b>Cabinets with 2 solid sheet hinged doors</b> |                    |                  |         |                    |          |                   |
| -   | 4                  | -                | 160     | Pin hinge          | KEY Lock | <b>98.081.XXX</b> |
| 1 × 100 /<br>1 × 150                            | 3                  | -                | 160/200 | Pin hinge          | KEY Lock | <b>98.085.XXX</b> |
| 2 × 100 /<br>2 × 150                            | 2                  | 1                | 160/200 | Pin hinge          | KEY Lock | <b>98.093.XXX</b> |

|  |   |   |         |           |          |                   |
|--|---|---|---------|-----------|----------|-------------------|
| <b>Cabinets with 2 viewing window hinged doors</b> |   |   |         |           |          |                   |
| -  | 4 | - | 160     | Pin hinge | KEY Lock | <b>98.082.XXX</b> |
| 1 × 100 /<br>1 × 150                               | 3 | - | 160/200 | Pin hinge | KEY Lock | <b>98.086.XXX</b> |
| 2 × 100 /<br>2 × 150                               | 2 | 1 | 160/200 | Pin hinge | KEY Lock | <b>98.094.XXX</b> |

## Hinged doors

- folded from a single piece
- either made of solid sheet steel or equipped with viewing windows
- with pin hinge, opening angle approx. 115°
- Lock with KEY, CODE or RFID Lock

**i** When ordering a cabinet from these two pages with **CODE** or **RFID Lock**, please add the suffix "**C**" or "**F**", respectively, to the article number stated in the table (e.g. **98.081.XXX.C**).



## Heavy-duty cabinets with roller shutter

The cabinets are equipped with: adjustable shelves, galvanised, 35 mm thick, pull-out shelves and drawers, painted, generally grey, NCS 4502-B. The smooth-running PVC roller shutter stops at any height without locking. Colour: aluminium colours, the colour of the strike plate with KEY Lock locking system is variable.

**54 × 27 E**      **H** ↑ 1950 mm      **W** → 1100 mm      **D** ↗ 641 mm



| Drawers                             | Adjustable shelves | Pull-out shelves | kg      | Hinge pins mounted |          | Art. no.          |
|-------------------------------------|--------------------|------------------|---------|--------------------|----------|-------------------|
| <b>Cabinets with roller shutter</b> |                    |                  |         |                    |          |                   |
| -                                   | 4                  | -                | 160     | -                  | KEY Lock | <b>98.083.XXX</b> |
| 2 × 100                             | 4                  | -                | 160/200 | -                  | KEY Lock | <b>98.091.XXX</b> |



## Roller shutter

- especially suitable when space is limited
- stops at any height without the need for catches
- aluminium colours, colour of strike plate variable
- KEY Lock locking system

**>>** For partition material sets and labelling system see p. 248.







Art. no. **98.096.010**  
Pale blue, RAL 5012

Art. no.  
**59.544.010**  
**59.532.010**  
Pale blue, RAL 5012

**i** Tilt protection is ensured by the multiple pull-out lock; only applies to retracting doors.

## Drawers

Drawers with different front heights can be incorporated into the same housing in any order. The insides of the drawer walls are all fitted with a slotted grid in units (E) of 17 mm so that each drawer can be partitioned as required. Colour: grey, NCS 4502-B.

## Pull-out shelves

For storing heavy individual items and equipment. Perfectly fitting, variable height assembly of 25 × 25 mm in the cabinet housing. The inserted slats enable stored items to be stored and removed flush with the handle. Specification: steel sheet. Colour: grey, NCS 4502-B. Slats are made of shaped sheet steel profile, sendzimir galvanised.

## Adjustable shelves, slotted or plain

Adjustable shelves including 4 shelf supports. Adjustable shelf, slotted, **fitting against the rear**. Specification: steel sheet, galvanised. Long sides folded 4 × 90°. Slotted partition; 50 mm. Load capacity: 160 kg.

## Dividers for adjustable shelves

Slotted for separating 2 adjustable shelves attached one above the other. The height of the dividers depends on the distance between the adjustable shelves. Specification: steel sheet. Colour: light grey, RAL 7035.

## Base

Robust steel tubing construction 40 × 40 mm, closed side panels, incl. fastening material (screw connection between cabinet and base). Optional: base cover to be attached as a cover on the front or rear. Colour: Anthracite grey, RAL 7016.

| <b>54 × 27 E</b>                          | <b>W</b> → × <b>D</b> ↗ | <b>1100 × 641</b>                  | <b>1146 × 690</b>       |
|---|-------------------------|------------------------------------|-------------------------|
| <b>H</b> ↑ <b>Cabinet height mm</b>       |                         | <b>1950</b>                        | <b>1950</b>             |
|   | Clear height (mm)       | 1790/1640                          | 1830                    |
|   | for design              | <b>Hinged doors roller shutter</b> | <b>Retracting doors</b> |
|   |                         | Art. no.                           | Art. no.                |
| <b>Housing</b>                            |                         | <b>98.096.XXX</b>                  | <b>59.544.XXX</b>       |
| <b>Hinged doors excl. clasp lock</b>      |                         |                                    |                         |
| Solid sheet                               |                         | <b>62.031.XXX</b>                  | -                       |
| Viewing window                            |                         | <b>62.032.XXX</b>                  | -                       |
| <b>Retracting doors excl. clasp lock</b>  |                         |                                    |                         |
| Solid sheet                               |                         | -                                  | <b>59.532.XXX</b>       |
| Viewing window                            |                         | -                                  | <b>59.535.XXX</b>       |
| <b>+ clasp lock</b>                       |                         |                                    |                         |
| Key Lock, separately lockable             |                         | <b>49.060.000</b>                  | <b>49.060.000</b>       |
| CODE Lock                                 |                         | <b>49.085.000</b>                  | <b>49.085.000</b>       |
| RFID Lock                                 |                         | <b>49.086.000</b>                  | <b>49.086.000</b>       |
| <b>Roller shutter excl. cylinder lock</b> |                         | <b>98.097.XXX</b>                  | -                       |
| + push handle cylinder lock               |                         | <b>62.062.000</b>                  | -                       |

| <b>H</b> ↑                | Usable height mm | Cladding height mm |                   |                   |
|---------------------------|------------------|--------------------|-------------------|-------------------|
| <b>Drawers</b>            |                  |                    |                   |                   |
| <b>75</b>                 | 57.5             | 49                 | <b>85.700.080</b> | <b>85.700.080</b> |
| <b>100</b>                | 82.5             | 76                 | <b>85.701.080</b> | <b>85.701.080</b> |
| <b>150</b>                | 132.5            | 126                | <b>85.702.080</b> | <b>85.702.080</b> |
| <b>200</b>                | 182.5            | 176                | <b>85.703.080</b> | <b>85.703.080</b> |
| Usable dimension W × D mm |                  |                    | 918 × 459         | 918 × 459         |
| Load capacity kg          |                  |                    | 200               | 200               |

|                           |                   |                   |
|---------------------------|-------------------|-------------------|
| <b>Pull-out shelf</b>     | <b>85.704.080</b> | <b>85.704.080</b> |
| Usable dimension W × D mm | 918 × 459         | 918 × 459         |
| Height mm                 | 75                | 75                |
| Load capacity kg          | 200               | 200               |

|                           |                   |                   |
|---------------------------|-------------------|-------------------|
| <b>Adjustable shelf</b>   | <b>98.098.000</b> | <b>59.545.000</b> |
| Usable dimension W × D mm | 967 × 549         | 966 × 500         |
| Height mm                 | 35                | 33                |
| Load capacity kg          | 160               | 160               |
| Model                     | Plain             | Slotted           |

|                 | Usable height mm | Distance between shelves TE-TE* mm |   |                   |
|-----------------|------------------|------------------------------------|---|-------------------|
| <b>Dividers</b> | 179              | 225                                | - | <b>59.415.000</b> |
|                 | 329              | 375                                | - | <b>59.416.000</b> |

\* Distance between shelves from top edge to top edge

|                       |                   |                   |
|-----------------------|-------------------|-------------------|
| <b>Base, H 150 mm</b> | <b>97.588.000</b> | <b>59.412.000</b> |
| <b>Base cover</b>     | <b>98.246.000</b> | <b>62.888.000</b> |

## Cabinet systems | Clothing lockers

**Clothing lockers from LISTA offer impressive functionality and a wide variety of equipment options.** This makes them suitable for use in a wide range of locations from workshop to sports hall and they also offer secure, flexible and ideal storage in accordance with DIN 4547-2011.



**+ Utmost stability**  
 thanks to hinged doors with the pin on the right and with reinforcement pocket for greater protection against burglary (DIN 4547)

**+ Sophisticated ventilation**  
 with air vents at the top and bottom of the housing

**+ Optimum hygiene**  
 thanks to plain compartment shelves without raised edge to make it easier to clean the compartments thoroughly

**+ Practical interior fittings**  
 with hat rack, towel holder and clothes rail with three sliding coat hooks for each compartment

**+ Individual equipment options**  
 such as housing with an inclined top, double compartments, benches or ventilation ducts for on-site forced ventilation

**+ Secure locking**  
 with KEY Lock locking system, rotary knob safety lock or closing device for padlock (CODE/RFID Lock and other locking systems on request)

**+ Protection from dirt and corrosion**  
 with bases or legs that are galvanised in addition to being powder-coated. Protect against corrosion, cover with a base also protects against dirt





Art. no. **94.424.080**  
Pigeon grey, NCS S 4502-B

## Clothing lockers

1-leaf for 1 lockable compartment

### Equipment per compartment

single-leaf solid sheet door, flush-fitting, surface plain or with perforated field for additional ventilation (1 compartment lockable)

1 hat rack

1 clothes rail, with 3 sliding coat hooks

1 towel holder

**Compartments width:** 300 or 400 mm

**Clear height:** 1280 mm / 300 mm (hat rack)



without substructure (for bases)



with feet



with base

|                      |                         |                        | 300 mm            |                   |                   | 400 mm            |                   |
|----------------------|-------------------------|------------------------|-------------------|-------------------|-------------------|-------------------|-------------------|
| compartment width    |                         |                        | 600               | 900               | 1200              | 800               | 1200              |
| <b>H</b> →           | <b>Cabinet width mm</b> |                        |                   |                   |                   |                   |                   |
| <b>W</b> ↗           | <b>500 mm</b>           | Number of compartments | 2                 | 3                 | 4                 | 2                 | 3                 |
| <b>D</b> ↑           |                         | Door specification     | Art. no.          | Art. no.          | Art. no.          | Art. no.          | Art. no.          |
| <b>1700 mm</b>       | KEY Lock                | plain                  | <b>94.414.XXX</b> | <b>94.405.XXX</b> | <b>94.417.XXX</b> | <b>94.420.XXX</b> | <b>94.411.XXX</b> |
| without substructure | KEY Lock                | perforated             | <b>94.531.XXX</b> | <b>94.534.XXX</b> | <b>94.537.XXX</b> | <b>94.543.XXX</b> | <b>94.546.XXX</b> |
| <b>1800 mm</b>       | KEY Lock                | plain                  | <b>94.426.XXX</b> | <b>94.429.XXX</b> | <b>94.432.XXX</b> | <b>94.438.XXX</b> | <b>94.441.XXX</b> |
| with base, 100 mm    | KEY Lock                | perforated             | <b>94.552.XXX</b> | <b>94.555.XXX</b> | <b>94.558.XXX</b> | <b>94.564.XXX</b> | <b>94.567.XXX</b> |
| <b>1850 mm</b>       | KEY Lock                | plain                  | <b>94.447.XXX</b> | <b>94.450.XXX</b> | <b>94.453.XXX</b> | <b>94.459.XXX</b> | <b>94.462.XXX</b> |
| with feet, 150 mm    | KEY Lock                | perforated             | <b>94.573.XXX</b> | <b>94.576.XXX</b> | <b>94.579.XXX</b> | <b>94.585.XXX</b> | <b>94.588.XXX</b> |



Art. no. **94.417.010**  
Light blue, RAL 5012



**i** Battery charging cabinets with clothes lockers can be found on page 210.



### Clothing lockers

1-leaf for 2 lockable compartments

#### Equipment per compartment

single-leaf solid sheet door, flush-fitting, surface plain or with perforated field for additional ventilation (2 compartments lockable)

- 1 hat rack
- 1 clothes rail, with 3 sliding coat hooks
- 1 towel holder

**Compartments width:** 300 mm  
**Clear height:** 1280 mm / 300 mm (hat rack)



#### Sophisticated ventilation system

- the air vents located on the top and bottom of the housing ensure permanent circulation of air in the locker
- door models with individual perforation pattern on request

|                      |                  | compartment width      |  | 300 mm            |                   |
|----------------------|------------------|------------------------|--|-------------------|-------------------|
| <b>H</b> →           | Cabinet width mm | 600                    |  | 1200              |                   |
| <b>W</b> ↗           | 500 mm           | Number of compartments |  | 2                 | 4                 |
| <b>D</b> ↑           | 🔒                | Door specification     |  | Art. no. 🌈        | Art. no. 🌈        |
| <b>1700 mm</b>       | KEY Lock         | plain                  |  | <b>94.302.XXX</b> | <b>94.305.XXX</b> |
| without substructure | KEY Lock         | perforated             |  | <b>94.320.XXX</b> | <b>94.323.XXX</b> |
| <b>1800 mm</b>       | KEY Lock         | plain                  |  | <b>94.308.XXX</b> | <b>94.311.XXX</b> |
| with base, 100 mm    | KEY Lock         | perforated             |  | <b>94.326.XXX</b> | <b>94.329.XXX</b> |
| <b>1850 mm</b>       | KEY Lock         | plain                  |  | <b>94.314.XXX</b> | <b>94.317.XXX</b> |
| with feet, 150 mm    | KEY Lock         | perforated             |  | <b>94.332.XXX</b> | <b>94.335.XXX</b> |



#### Air duct

Elimination of odours thanks to high air exchange rate and improved drying through on-site forced ventilation.

Air duct on request.

### Clothing lockers

2-leaf for 2 lockable compartments

#### Equipment per compartment

2 solid leaf door, flush fitting, surface plain or with perforated field for additional ventilation (2 compartments lockable)

- 1 hat rack
- 1 clothes rail, with 3 sliding coat hooks
- 1 towel holder

**Compartments width:** 300 or 400 mm  
**Clear height:** 1280 mm / 300 mm (hat rack)



#### Inclined top

Clothes lockers with an inclined top prevent undesired use of the cabinet top as shelf space.

Inclined top on request.

|                      |                  | compartment width      |  | 300 mm            |                   | 400 mm            |  |
|----------------------|------------------|------------------------|--|-------------------|-------------------|-------------------|--|
| <b>H</b> →           | Cabinet width mm | 600                    |  | 1200              |                   | 800               |  |
| <b>W</b> ↗           | 500 mm           | Number of compartments |  | 2                 | 4                 | 2                 |  |
| <b>D</b> ↑           | 🔒                | Door specification     |  | Art. no. 🌈        | Art. no. 🌈        | Art. no. 🌈        |  |
| <b>1700 mm</b>       | KEY Lock         | plain                  |  | <b>94.342.XXX</b> | <b>94.348.XXX</b> | <b>94.345.XXX</b> |  |
| without substructure | KEY Lock         | perforated             |  | <b>94.369.XXX</b> | <b>94.375.XXX</b> | <b>94.372.XXX</b> |  |
| <b>1800 mm</b>       | KEY Lock         | plain                  |  | <b>94.351.XXX</b> | <b>94.357.XXX</b> | <b>94.354.XXX</b> |  |
| with base, 100 mm    | KEY Lock         | perforated             |  | <b>94.378.XXX</b> | <b>94.384.XXX</b> | <b>94.381.XXX</b> |  |
| <b>1850 mm</b>       | KEY Lock         | plain                  |  | <b>94.360.XXX</b> | <b>94.366.XXX</b> | <b>94.363.XXX</b> |  |
| with feet, 150 mm    | KEY Lock         | perforated             |  | <b>94.387.XXX</b> | <b>94.393.XXX</b> | <b>94.390.XXX</b> |  |



#### Wide range of accessories

On request, you may also order benches, shoe racks, name and number plates, towel holders and more.



#### Versatile locking systems

cylinder locks, numeric combination locks, coin deposit locks, locking systems for padlocks and master key systems are available. Other locks available on request.

**i** When ordering a clothes locker from this double page with **closing device for padlock**, please specify the suffix **"V"**, or, for **rotary knob safety lock**, use the suffix **"D"** in addition to the article number from the table (e.g. **94.429.XXX.V**)



#### Base makes cleaning simpler

The closed base border on the floor makes it easy to clean changing room areas.



# Cabinet systems | Dual-level clothing lockers



Art. No. **94.424.080**  
Pigeon grey, NCS S 4502-B

## Dual-level clothing lockers

### equipment for each compartment

- single-leaf solid sheet door, flush-fitting, surface plain or with perforated field for additional ventilation (1 compartment lockable)
- 1 hat rack
- 1 clothes rail, with 3 sliding coat hooks
- 1 towel holder

**Compartments width:** 300 or 400 mm  
**Clear height:** 1280 mm (for top and bottom compartment)



without substructure (for bases)



with feet



with base

|                             |                        | 300 mm            |                   |                   | 400 mm            |                   |
|-----------------------------|------------------------|-------------------|-------------------|-------------------|-------------------|-------------------|
| <b>H</b> → Cabinet width mm | compartment width      | 600               | 900               | 1200              | 800               | 1200              |
| <b>W</b> ↗ 500 mm           | Number of compartments | 2 × 2             | 3 × 2             | 4 × 2             | 2 × 2             | 3 × 2             |
| <b>D</b> ↑                  | Door specification     | Art. no.          | Art. no.          | Art. no.          | Art. no.          | Art. no.          |
| <b>1700 mm</b>              | KEY Lock plain         | <b>94.468.XXX</b> | <b>94.471.XXX</b> | <b>94.474.XXX</b> | <b>94.480.XXX</b> | <b>94.483.XXX</b> |
| without substructure        | KEY Lock perforated    | <b>94.594.XXX</b> | <b>94.597.XXX</b> | <b>94.600.XXX</b> | <b>94.606.XXX</b> | <b>94.609.XXX</b> |
| <b>1800 mm</b>              | KEY Lock plain         | <b>94.489.XXX</b> | <b>94.492.XXX</b> | <b>94.495.XXX</b> | <b>94.501.XXX</b> | <b>94.504.XXX</b> |
| with base, 100 mm           | KEY Lock perforated    | <b>94.615.XXX</b> | <b>94.618.XXX</b> | <b>94.621.XXX</b> | <b>94.627.XXX</b> | <b>94.630.XXX</b> |
| <b>1850 mm</b>              | KEY Lock plain         | <b>94.510.XXX</b> | <b>94.513.XXX</b> | <b>94.516.XXX</b> | <b>94.522.XXX</b> | <b>94.525.XXX</b> |
| with feet, 150 mm           | KEY Lock perforated    | <b>94.636.XXX</b> | <b>94.639.XXX</b> | <b>94.642.XXX</b> | <b>94.648.XXX</b> | <b>94.651.XXX</b> |





|                             |            |            |            |             |
|-----------------------------|------------|------------|------------|-------------|
| <b>H</b> → Cabinet width mm | <b>600</b> | <b>800</b> | <b>900</b> | <b>1200</b> |
|-----------------------------|------------|------------|------------|-------------|



### Single- or double-sided base, height 150 mm

Welded steel construction with angle profiles and adjustable plastic legs for levelling. Colour: Anthracite grey, RAL 7016.  
**Note:** double-sided (for 2 cabinets, back to back)

#### Base, H 150 mm

| <b>W</b> ↗ mm | Model        | Art. no.   | Art. no.   | Art. no.   | Art. no.   |
|---------------|--------------|------------|------------|------------|------------|
| 500           | single-sided | 94.252.000 | 94.253.000 | 94.254.000 | 94.255.000 |
| 1000          | double-sided | 94.264.000 | 94.265.000 | 94.266.000 | 94.267.000 |

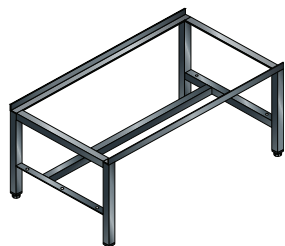

### Single-sided or double-sided base, height 400 mm

Welded steel construction with angle profiles and adjustable plastic legs for levelling. Colour: Anthracite grey, RAL 7016.  
**Note:** double-sided (for 2 cabinets, back to back)

#### Base, H 400 mm

| <b>W</b> ↗ mm | Model        | Art. no.   | Art. no.   | Art. no.   | Art. no.   |
|---------------|--------------|------------|------------|------------|------------|
| 500           | single-sided | 97.110.000 | 97.473.000 | 97.143.000 | 97.111.000 |
| 1000          | double-sided | 97.108.000 | 98.444.000 | 97.870.000 | 97.109.000 |

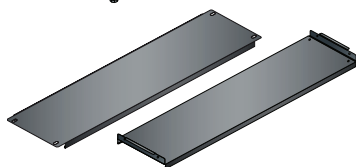

#### Shoe rack

| <b>W</b> ↗ mm | Model        | Art. no.   | Art. no.   | Art. no.   | Art. no.   |
|---------------|--------------|------------|------------|------------|------------|
| 230           | secure       | 97.156.000 | 97.472.000 | 97.144.000 | 97.157.000 |
| 230           | folds upward | 98.230.000 | 98.683.000 | 98.617.000 | 98.231.000 |



### Single-sided or double-sided base, height 400 mm

Welded steel construction with angle profiles and adjustable plastic legs for levelling. Colour: Anthracite grey, RAL 7016.  
**Note:** double-sided (for 2 cabinets, back to back). Bench depth: 300 mm.

#### Base, H 400 mm

| <b>W</b> ↗ mm | Model        | Art. no.   | Art. no.   | Art. no.   | Art. no.   |
|---------------|--------------|------------|------------|------------|------------|
| 500           | single-sided | 94.946.000 | 94.947.000 | 94.948.000 | 94.949.000 |
| 1000          | double-sided | 94.950.000 | 94.951.000 | 94.952.000 | 94.953.000 |



### Fixed or fold-up shoe rack

Can be attached to the bases using attachment brackets without screws. Number required: 1 per clothes locker. Colour: Attachment brackets anthracite grey, RAL 7016; shoe racks galvanised anthracite grey, RAL 7016. Bench depth: 300 mm.

#### Shoe rack

| <b>W</b> ↗ mm | Model                      | Art. no.   | Art. no.   | Art. no.   | Art. no.   |
|---------------|----------------------------|------------|------------|------------|------------|
| 230           | secure                     | 94.954.000 | 94.955.000 | 94.956.000 | 94.957.000 |
|               | Distance between stands mm | 310        | 510        | 610        | 910        |
|               | Shelf length mm            | 336        | 536        | 636        | 936        |
| 230           | folds upward               | 94.966.000 | 94.967.000 | 94.968.000 | 94.696.000 |
|               | Distance between stands mm | 310        | 510        | 610        | 910        |
|               | Shelf length mm            | 285        | 485        | 585        | 885        |



### Bench base for in-line installation on request

Upon presentation of a layout plan, the bases are available at **little cost** for single- and/or double-sided construction in a row. In addition, less cleaning is required thanks the small number of leg supports.



### Double-sided base, height 400 mm with shoe racks

**LISTA compartment cabinets are ideal for storing personal items of all kinds.** Whether in industry, trades, office and administration, or leisure and sport: a variety of locking systems makes the cabinets easily adaptable to the respective security requirements of any location.

### + **Utmost stability**

thanks to hinged doors with the pin on the right, rolled on all sides, with curved surface

### + **Sophisticated ventilation**

with air vents at the top and bottom of the door

### + **Secure locking**

with KEY Lock locking system or locking mechanism for padlock (CODE/RFID Lock and other locking systems on request)

### + **Clearly labelled**

thanks to embossed label frame

### + **Protection from dirt**

thanks to substructure with base to prevent dirt from accumulating under the locker



Art. no. **11.527.050**  
Metallic grey, NCS S 6502-B



Art. no. **11.529.010**  
Light blue, RAL 5012



### Compartment doors

Different compartment doors, e.g. with viewing windows or mail slot, on request



### Inclined top part

An inclined top part prevents the cover from being used inadvertently as shelf space and reduces required cleaning.

### Ventilation slots and label frames

The high-quality solid sheet doors provide very high stability and are also equipped with a label frame. Air vents at the top and bottom provide ideal ventilation.

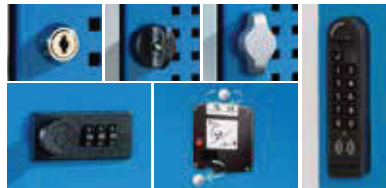

### Versatile locking systems

cylinder locks, numeric combination locks, coin deposit locks, locking systems for padlocks and master key systems are available. Other locking devices such as CODE/RFID Lock on request.

### i Ordering information



When ordering a compartment cabinet with **closing device for a padlock**, please specify the suffix **"V"** or, for a **rotary knob safety lock**, the suffix **"D"** in addition to the article number from the table (e.g. **11.525.XXX.V**).



|   |                                      | Compartment width        |            |                   | 400 mm                     |                   |   |
|---|--------------------------------------|--------------------------|------------|-------------------|----------------------------|-------------------|---|
|   |                                      | 300 mm                   |            |                   | 400 mm                     |                   |   |
|   |                                      | Clear compartment width  |            |                   | 340 mm                     |                   |   |
| <b>D</b> ↗ 500 mm                           | <b>W</b> → Cabinet width mm          | <b>610</b>               | <b>905</b> | <b>1200</b>       | <b>415</b>                 | <b>810</b>        | <b>1205</b>   |
| <b>H</b> ↑                                  | <b>H</b> ↑                           | Number of compartments ↔ |            |                   |                            |                   |   |
| with base H 150 mm                          | Compartment Clear compartment height | 2                        | 3          | 4                 | 1                          | 2                 | 3   |
|   | Number of compartments               | Art. no.                 | Art. no.   | Art. no.          | Art. no.                   | Art. no.          | Art. no.  |
| <b>1095 mm</b>                              | 300 mm<br>280 mm                     | 3                        | KEY Lock   | Art. no. -        | Art. no. <b>11.513.XXX</b> | -                 | -   |
| <b>1395 mm</b>                              | 300 mm<br>280 mm                     | 4                        | KEY Lock   | <b>11.507.XXX</b> | <b>11.515.XXX</b>          | -                 | -   |
| <b>1695 mm</b>                              | 300 mm<br>280 mm                     | 5                        | KEY Lock   | <b>11.509.XXX</b> | <b>11.517.XXX</b>          | <b>11.521.XXX</b> | -   |
| <b>1795 mm</b>                              | 400 mm<br>380 mm                     | 4                        | KEY Lock   | <b>11.501.XXX</b> | <b>11.503.XXX</b>          | <b>11.505.XXX</b> | <b>11.525.XXX</b> <b>11.527.XXX</b> <b>11.529.XXX</b> |
| <b>1995 mm</b>                              | 300 mm<br>280 mm                     | 6                        | KEY Lock   | <b>11.511.XXX</b> | <b>11.519.XXX</b>          | <b>11.523.XXX</b> | -   |
| <b>inclined top part, H 50/200 mm</b>       |                                      |                          |            | <b>97.315.000</b> | <b>97.316.000</b>          | <b>97.317.000</b> | <b>97.318.000</b> <b>97.319.000</b> <b>97.320.000</b> |
| for mounting superstructures at the factory |                                      |                          |            | <b>97.558.000</b> | <b>97.558.000</b>          | <b>97.558.000</b> | <b>97.558.000</b> <b>97.558.000</b> <b>97.558.000</b> |

**COLOURS:** With preconfigured cabinets housing in light grey, RAL 7035.





**LISTA battery charging cabinets with hinged doors are perfect for the centralised supply of batteries and electrical devices.** All cabinets can be configured individually and adapted to your specific storage needs through the flexible use of partition materials, cabinet accessories and power supply by means of power strips.

## + Flexible range of applications

Charging options for battery-operated electrical machines, BDE devices, notebooks, tablets and smartphones

## + Perfect cable management

Cable openings for protected and orderly cable routing

## + Outstanding safety features

CE compliant

## + Secure locking

Devices are locked away at all times, and are protected against unauthorised use and with intelligent locking systems such as CODE/RFID Lock.

## >> Benefits of LISTA cabinet systems

See p. 168

### Battery charging cabinets with hinged doors

Depending on the model, the cabinets are equipped with **adjustable shelves**, galvanised, 30 mm thick, load capacity 60 kg. Painted **drawers**, anthracite gray (RAL 7016), load capacity 50 kg. **Power strips** with on/off switches and 4 or 5 sockets, 230 V.



Art. No. **62.955.020**  
Solid sheet hinged door,  
light grey (RAL 7035)

Art. No. **62.976.020**  
Viewing window hinged door,  
light grey (RAL 7035)

Art. No. **62.959.020**  
Solid sheet hinged door,  
light grey (RAL 7035)



#### Hinged doors with viewing windows

- For greater transparency of stored items
- Encourages order

**i** When ordering a cabinet from these two pages with **CODE** or **RFID Lock**, please add the suffix "**C**" or "**F**", respectively, to the article number stated in the table (e.g. **62.955.XXX.C**).



|                    |                   |                    |                   |                 |
|--------------------|-------------------|--------------------|-------------------|-----------------|
| <b>W</b> → 1000 mm | <b>D</b> ↗ 580 mm | <b>H</b> ↑ 1950 mm | Solid sheet doors | Viewing windows |
|--------------------|-------------------|--------------------|-------------------|-----------------|

| Number of power strips          | Mounting position, power strips | Adjustable shelves | Drawers | kg    | Door storage |          | Art. No.          | Art. No.          |
|---------------------------------|---------------------------------|--------------------|---------|-------|--------------|----------|-------------------|-------------------|
| <b>Model D / Schuko</b>         |                                 |                    |         |       |              |          |                   |                   |
| 1 × 5-socket (230V)             | On side panel                   | 4                  | –       | 60    | Hinge        | KEY Lock | <b>62.954.XXX</b> | <b>62.972.XXX</b> |
| 2 × 5-socket (230V)             | On side panel                   | 4                  | –       | 60    | Hinge        | KEY Lock | <b>62.955.XXX</b> | <b>62.973.XXX</b> |
| 1 × 5-socket (230V)             | On rear panel/power conduit     | 4                  | –       | 60    | Hinge        | KEY Lock | <b>62.956.XXX</b> | <b>62.974.XXX</b> |
| 2 × 5-socket (230V)             | On rear panel/power conduit     | 4                  | –       | 60    | Hinge        | KEY Lock | <b>62.957.XXX</b> | <b>62.975.XXX</b> |
| 2 × 5-socket (230V)             | On rear panel/power conduit     | 3                  | 2 × 95  | 60/50 | Hinge        | KEY Lock | <b>62.959.XXX</b> | <b>62.977.XXX</b> |
| 2 × 5-socket (230V), RCD/MCB**  | On rear panel/power conduit     | 4                  | –       | 60    | Hinge        | KEY Lock | <b>62.958.XXX</b> | <b>62.976.XXX</b> |
| <b>Model CH</b>                 |                                 |                    |         |       |              |          |                   |                   |
| 1 × 4-socket (230V)*            | On side panel                   | 4                  | –       | 60    | Hinge        | KEY Lock | <b>62.966.XXX</b> | <b>62.984.XXX</b> |
| 2 × 4-socket (230V)*            | On side panel                   | 4                  | –       | 60    | Hinge        | KEY Lock | <b>62.967.XXX</b> | <b>62.985.XXX</b> |
| 1 × 4-socket (230V)*            | On rear panel/power conduit     | 4                  | –       | 60    | Hinge        | KEY Lock | <b>62.968.XXX</b> | <b>62.986.XXX</b> |
| 2 × 4-socket (230V)*            | On rear panel/power conduit     | 4                  | –       | 60    | Hinge        | KEY Lock | <b>62.969.XXX</b> | <b>62.987.XXX</b> |
| 2 × 4-socket (230V)*            | On rear panel/power conduit     | 3                  | 2 × 95  | 60/50 | Hinge        | KEY Lock | <b>62.971.XXX</b> | <b>62.989.XXX</b> |
| 2 × 4-socket (230V)*, RCD/MCB** | On rear panel/power conduit     | 4                  | –       | 60    | Hinge        | KEY Lock | <b>62.970.XXX</b> | <b>62.988.XXX</b> |
| <b>Model F</b>                  |                                 |                    |         |       |              |          |                   |                   |
| 1 × 5-socket (230V)             | On side panel                   | 4                  | –       | 60    | Hinge        | KEY Lock | <b>62.960.XXX</b> | <b>62.978.XXX</b> |
| 2 × 5-socket (230V)             | On side panel                   | 4                  | –       | 60    | Hinge        | KEY Lock | <b>62.961.XXX</b> | <b>62.979.XXX</b> |
| 1 × 5-socket (230V)             | On rear panel/power conduit     | 4                  | –       | 60    | Hinge        | KEY Lock | <b>62.962.XXX</b> | <b>62.980.XXX</b> |
| 2 × 5-socket (230V)             | On rear panel/power conduit     | 4                  | –       | 60    | Hinge        | KEY Lock | <b>62.963.XXX</b> | <b>62.981.XXX</b> |
| 2 × 5-socket (230V)             | On rear panel/power conduit     | 3                  | 2 × 95  | 60/50 | Hinge        | KEY Lock | <b>62.965.XXX</b> | <b>62.983.XXX</b> |
| 2 × 5-socket (230V), RCD/MCB**  | On rear panel/power conduit     | 4                  | –       | 60    | Hinge        | KEY Lock | <b>62.964.XXX</b> | <b>62.982.XXX</b> |
| <b>Model GB</b>                 |                                 |                    |         |       |              |          |                   |                   |
| 1 × 5-socket (230V)             | On side panel                   | 4                  | –       | 60    | Hinge        | KEY Lock | <b>57.145.XXX</b> | <b>57.151.XXX</b> |
| 2 × 5-socket (230V)             | On side panel                   | 4                  | –       | 60    | Hinge        | KEY Lock | <b>57.146.XXX</b> | <b>57.152.XXX</b> |
| 1 × 5-socket (230V)             | On rear panel/power conduit     | 4                  | –       | 60    | Hinge        | KEY Lock | <b>57.147.XXX</b> | <b>57.153.XXX</b> |
| 2 × 5-socket (230V)             | On rear panel/power conduit     | 4                  | –       | 60    | Hinge        | KEY Lock | <b>57.148.XXX</b> | <b>57.154.XXX</b> |
| 2 × 5-socket (230V)             | On rear panel/power conduit     | 3                  | 2 × 95  | 60/50 | Hinge        | KEY Lock | <b>57.150.XXX</b> | <b>57.156.XXX</b> |
| 2 × 5-socket (230V), RCD/MCB**  | On rear panel/power conduit     | 4                  | –       | 60    | Hinge        | KEY Lock | <b>57.149.XXX</b> | <b>57.155.XXX</b> |

\* With 1 × thermal fuse

\*\* RCD = residual current protective device (16A/30 mA), MCB = miniature circuit breaker (CH = 10 A, D/F = 16 A)

50 drawers/pull-out shelves  
 60 adjustable shelves

# Cabinet systems | Battery charging cabinets with hinged doors

**W** → Cabinet width mm

**750**

**1000**

**1250**



## Cabinet housing

incl. rubber grommets for protected cable feed through perforated rear panel in housing (punch-out) for optional fan installation.

| <b>D</b> ↗ | <b>H</b> ↑ | Door storage | Art. No. 🌈 | Art. No. 🌈 | Art. No. 🌈 |
|------------|------------|--------------|------------|------------|------------|
| 500 mm     | 1000 mm    | Hinge        | -          | 62.779.XXX | -          |
| 500 mm     | 1950 mm    | Hinge        | 62.792.XXX | 62.780.XXX | 62.794.XXX |
| 580 mm     | 1000 mm    | Hinge        | -          | 62.777.XXX | -          |
| 580 mm     | 1950 mm    | Hinge        | 62.793.XXX | 62.778.XXX | 62.795.XXX |



## Hinged doors

2 doors excl. clasp lock (must be ordered separately)

|                       | <b>H</b> ↑ | Door storage | Art. No. 🌈 | Art. No. 🌈 | Art. No. 🌈 |
|-----------------------|------------|--------------|------------|------------|------------|
| <b>Solid sheet</b>    | 1000 mm    | Hinge        | -          | 62.009.XXX | -          |
| <b>Solid sheet</b>    | 1950 mm    | Hinge        | 62.006.XXX | 62.011.XXX | 62.016.XXX |
| <b>Viewing window</b> | 1000 mm    | Hinge        | -          | 62.137.XXX | -          |
| <b>Viewing window</b> | 1950 mm    | Hinge        | -          | 62.012.XXX | 62.017.XXX |

## Adjustable shelf

Incl. 4 shelf supports. Specification: sheet steel, galvanised, slotted. Long sides folded by 4 × 90°. 30 mm thick with load-bearing capacity of 60 or 100 kg.

| <b>D</b> ↗                   | For cabinet depth | <b>kg</b> | Art. No.      | Art. No.      | Art. No.       |
|------------------------------|-------------------|-----------|---------------|---------------|----------------|
| 500 mm                       |                   | 60        | 58.104.000    | 58.107.000    | 58.110.000     |
| 500 mm                       |                   | 100       | -             | 60.407.000    | 60.408.000     |
| 580 mm                       |                   | 60        | 58.105.000    | 58.108.000    | 58.111.000     |
| 580 mm                       |                   | 100       | -             | 60.409.000    | 60.434.000     |
| Usable dimensions (W × D mm) |                   |           | 730 × 425/506 | 980 × 425/506 | 1230 × 425/506 |



## Divider for adjustable shelf

For partitioning adjustable shelves. Specification: sheet steel, painted. Colour: light grey, RAL 7035.

| <b>D</b> ↗ | For cabinet depth | Art. No.   | Art. No.   | Art. No.   |
|------------|-------------------|------------|------------|------------|
| 500 mm     | W 411 × H 150 mm  | 58.145.000 | 58.145.000 | 58.145.000 |
| 580 mm     | W 490 × H 150 mm  | 58.146.000 | 58.146.000 | 58.146.000 |

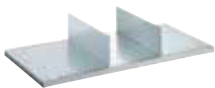

## Drawers and pull-out shelves

Full extension with ball bearings, including guide rails. Load capacity 50 kg. Specification: sheet steel. Colour: anthracite gray, RAL 7016. Only compatible with cabinets with hinge bearing assembly and a depth of 580 mm.

|                                 |                                  | Art. No.       | Art. No.        | Art. No.         |
|---------------------------------|----------------------------------|----------------|-----------------|------------------|
| <b>Drawer, FH 95 mm</b>         |                                  | 62.308.000     | 58.113.000      | 57.481.000       |
| <b>580 mm</b>                   | Usable dimensions (W × D × H mm) | 617 × 459 × 72 | 867 × 459 × 72  | 1117 × 459 × 72  |
| <b>Drawer, FH 145 mm</b>        |                                  | -              | 57.471.000      | 57.482.000       |
| <b>580 mm</b>                   | Usable dimensions (W × D × H mm) |                | 867 × 459 × 122 | 1117 × 459 × 122 |
| <b>Pull-out shelf, FH 53 mm</b> |                                  | -              | 58.115.000      | -                |
| <b>580 mm</b>                   | Usable dimensions (W × D × H mm) |                | 867 × 459 × 43  |                  |



## Base

Robust steel tubing construction 40 × 40 mm, closed side panels. Includes fastening material (screw connection between cabinet and base). Optional: base cover to be attached as a cover on the front or rear. Colour: Anthracite grey, RAL 7016.

|                             | Art. No.   | Art. No.   | Art. No.   |
|-----------------------------|------------|------------|------------|
| <b>Base*, FH 150 mm</b>     |            |            |            |
| <b>500 mm</b>               | 97.844.000 | 98.518.000 | 98.253.000 |
| <b>580 mm</b>               | 98.657.000 | 98.216.000 | 97.835.000 |
| <b>Base cover, H 150 mm</b> | 57.238.000 | 97.986.000 | 62.806.000 |

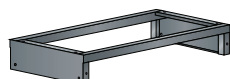

## Punch out

perforated rear housing panel for optional installation of a fan



## Hinged bearing assembly

- For the installation of drawers and pull-out shelves, doors must be fitted with hinged bearing assembly
- Doors are flush with the cabinet housing
- Opening angle approx. 115°



## KEY Lock

Art. No. 49.060.000  
Separately lockable



## CODE Lock

Art. No. 49.085.000



## RFID Lock

Art. No. 49.086.000



### Power strips

With on/off switch and sockets, 230 V, without power and connection cables

| For cabinet depth | Type   | Description      | Art. No.          |
|-------------------|--------|------------------|-------------------|
| 500 mm            | D / PE | 4-socket (230V)  | <b>82.474.000</b> |
| 500 mm            | CH     | 3-socket (230V)* | <b>82.475.000</b> |
| 500 mm            | F      | 4-socket (230V)  | <b>82.476.000</b> |
| 500 mm            | GB     | 4-socket (230V)  | <b>62.902.000</b> |
| 580 mm            | D / PE | 5-socket (230V)  | <b>62.763.000</b> |
| 580 mm            | CH     | 4-socket (230V)* | <b>62.782.000</b> |
| 580 mm            | F      | 5-socket (230V)  | <b>62.739.000</b> |
| 580 mm            | GB     | 5-socket (230V)  | <b>62.903.000</b> |

\* Incl. thermal fuse 10A



Side panel installation

### Fastening kit for power strips

#### Side panel installation

Includes fastening material for screw connection of the power strips onto the cabinet side panel

| For cabinet depth | Art. No.          |
|-------------------|-------------------|
| 500 mm            | <b>62.771.000</b> |
| 580 mm            | <b>62.772.000</b> |

#### Rear panel installation

Power conduit for holding the power strips (4-socket for CH and 5-socket for D, F and GB). Fastening material included. Specification: sheet steel. Colour: anthracite gray, RAL 7016.

| For cabinet width | Art. No.          |
|-------------------|-------------------|
| 1000 mm           | <b>62.992.000</b> |
| 1250 mm           | <b>62.996.000</b> |



Rear panel installation

### Cable fastening

Cable tie and mounting base kit for 2 m cable length

| Quantity | Art. No.           |
|----------|--------------------|
| 5 pieces | <b>390.024.000</b> |

### Fan

Incl. adapter with integrated European plug  
For GB, an adapter is required, art. no. **61.160.000**.

| Type       | Art. No.          |
|------------|-------------------|
| 12V DC 106 | <b>57.467.000</b> |



### RCD/MCB

RCD = residual current protective device (16 A)  
MCB = miniature circuit breaker (CH = 10 A, D/F = 16 A)

| Quantity | Art. No.          |
|----------|-------------------|
| 1 piece  | <b>57.101.000</b> |



### System socket supply cable

Simple and quick electrical installation through plug and socket connector system, 3-pin.

| Type   | Length (m) | Art. No.          |
|--------|------------|-------------------|
| D / PE | 3.0        | <b>89.545.000</b> |
| CH     | 3.0        | <b>89.544.000</b> |
| F      | 3.0        | <b>89.545.000</b> |
| GB     | 3.0        | <b>89.546.000</b> |



### Connecting cable

3-pin connector system with plug and socket

| Length (m) | Art. No.           |
|------------|--------------------|
| 1.0        | <b>89.548.000</b>  |
| 1.5        | <b>390.036.000</b> |
| 2.0        | <b>89.549.000</b>  |
| 3.0        | <b>89.550.000</b>  |

**i** Intermediate coupling required to connect RCD to power strip, art. no. **89.552.000**.

### LED cabinet lighting

12 V LED lighting for cabinet height 1950 mm. Installed at the front right of the cabinet. Consisting of 1 LED light each, length: 800 mm (9W) and 500 mm (5W), integrated motion detector requires 1 free slot in one power strip.

Art. No. **57.463.000**



### + Flexible range of applications

Charging options for battery-operated electrical machines, BDE devices, notebooks, tablets, smartphones or e-bikes

### + Sophisticated ventilation

Optimal air circulation thanks to ventilation holes at the front and back

### + Great design diversity

With sockets, network sockets RJ45 and USB interfaces

### + Outstanding safety features

CE compliant

### + Secure locking

Devices are locked away at all times, and are protected against unauthorised use and with intelligent locking systems such as CODE/RFID Lock

### >> Benefits of LISTA cabinet systems

See p. 168

**LISTA compartment cabinets with power connection are perfect for personal storage of battery-operated devices of all kinds.** Suitable for use in industry, trade, offices, schools, universities or public buildings. Batteries can be charged during storage thanks to the built-in double sockets, and are therefore always ready to use.



Art. no. **98.409.020**  
Light grey, RAL 7035



Art. no. **98.416.070**  
Ruby red, RAL 3003

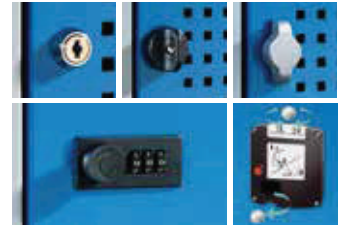

**Versatile locking systems**

▪ Cylinder locks, numeric combination locks, coin deposit locks, locking systems for padlocks and master key systems are available

**i** When ordering a cabinet from this page with **RFID Lock**, please add the suffix **"F"**, respectively, to the article number stated in the table (e.g. **98.409.XXX.F**).

**H** **1795 mm, with base 150 mm high**

**W** **D** No. of compartments Shelf dimension (W x H mm) Type Module per compartment Art. no.

**Cabinets with 8 compartments and KEY Lock**

|               |        |       |           |        |                    |                   |
|---------------|--------|-------|-----------|--------|--------------------|-------------------|
| <b>810 mm</b> | 585 mm | 2 x 4 | 400 x 400 | D / PE | 2 x 230V           | <b>98.409.XXX</b> |
| <b>810 mm</b> | 585 mm | 2 x 4 | 400 x 400 | D / PE | 1 x 230V, 2 x USB  | <b>98.415.XXX</b> |
| <b>810 mm</b> | 585 mm | 2 x 4 | 400 x 400 | D / PE | 1 x 230V, 1 x RJ45 | <b>98.419.XXX</b> |
| <b>810 mm</b> | 585 mm | 2 x 4 | 400 x 400 | CH     | 2 x 230V           | <b>98.411.XXX</b> |
| <b>810 mm</b> | 585 mm | 2 x 4 | 400 x 400 | CH     | 1 x 230V, 2 x USB  | <b>98.629.XXX</b> |
| <b>810 mm</b> | 585 mm | 2 x 4 | 400 x 400 | CH     | 1 x 230V, 1 x RJ45 | <b>98.631.XXX</b> |
| <b>810 mm</b> | 585 mm | 2 x 4 | 400 x 400 | F      | 2 x 230V           | <b>98.413.XXX</b> |
| <b>810 mm</b> | 585 mm | 2 x 4 | 400 x 400 | F      | 1 x 230V, 2 x USB  | <b>98.417.XXX</b> |
| <b>810 mm</b> | 585 mm | 2 x 4 | 400 x 400 | F      | 1 x 230V, 1 x RJ45 | <b>98.421.XXX</b> |
| <b>810 mm</b> | 585 mm | 2 x 4 | 400 x 400 | GB     | 2 x 230V           | <b>98.455.XXX</b> |
| <b>810 mm</b> | 585 mm | 2 x 4 | 400 x 400 | GB     | 1 x 230V, 2 x USB  | <b>98.457.XXX</b> |
| <b>810 mm</b> | 585 mm | 2 x 4 | 400 x 400 | GB     | 1 x 230V, 1 x RJ45 | <b>98.459.XXX</b> |

**Cabinets with 12 compartments and KEY Lock**

|                |        |       |           |        |                    |                   |
|----------------|--------|-------|-----------|--------|--------------------|-------------------|
| <b>1205 mm</b> | 585 mm | 3 x 4 | 400 x 400 | D / PE | 2 x 230V           | <b>98.410.XXX</b> |
| <b>1205 mm</b> | 585 mm | 3 x 4 | 400 x 400 | D / PE | 1 x 230V, 2 x USB  | <b>98.416.XXX</b> |
| <b>1205 mm</b> | 585 mm | 3 x 4 | 400 x 400 | D / PE | 1 x 230V, 1 x RJ45 | <b>98.420.XXX</b> |
| <b>1205 mm</b> | 585 mm | 3 x 4 | 400 x 400 | CH     | 2 x 230V           | <b>98.412.XXX</b> |
| <b>1205 mm</b> | 585 mm | 3 x 4 | 400 x 400 | CH     | 1 x 230V, 2 x USB  | <b>98.630.XXX</b> |
| <b>1205 mm</b> | 585 mm | 3 x 4 | 400 x 400 | CH     | 1 x 230V, 1 x RJ45 | <b>98.632.XXX</b> |
| <b>1205 mm</b> | 585 mm | 3 x 4 | 400 x 400 | F      | 2 x 230V           | <b>98.414.XXX</b> |
| <b>1205 mm</b> | 585 mm | 3 x 4 | 400 x 400 | F      | 1 x 230V, 2 x USB  | <b>98.418.XXX</b> |
| <b>1205 mm</b> | 585 mm | 3 x 4 | 400 x 400 | F      | 1 x 230V, 1 x RJ45 | <b>98.422.XXX</b> |
| <b>1205 mm</b> | 585 mm | 3 x 4 | 400 x 400 | GB     | 2 x 230V           | <b>98.456.XXX</b> |
| <b>1205 mm</b> | 585 mm | 3 x 4 | 400 x 400 | GB     | 1 x 230V, 2 x USB  | <b>98.458.XXX</b> |
| <b>1205 mm</b> | 585 mm | 3 x 4 | 400 x 400 | GB     | 1 x 230V, 1 x RJ45 | <b>98.460.XXX</b> |



**2 x socket, 230V**



**Socket 230V/RJ45, without network cable, Plug+Play, Cat6**



**Socket 230V/Power USB**

**>>** For power modules, see. p. 145

**i** **On request**  
Doors with viewing windows





**LISTA clothes lockers and laptop cabinets with power outlets are perfect for personal storage of battery-powered devices of all kinds**, whether in industry, trade, offices, schools, universities or public buildings. Batteries can be charged during storage thanks to the built-in sockets and are therefore always ready to use.

### + **Utmost stability**

thanks to hinged doors with the pin on the right and with reinforcement pocket for greater protection against burglary (DIN 4547)

### + **Sophisticated ventilation**

with air vents at the top and bottom of the housing

### + **Optimum hygiene**

thanks to plain compartment shelves without raised edge to make it easier to clean the compartments thoroughly

### + **Practical interior fittings**

with hat rack, towel holder and clothes rail with three sliding coat hooks for each compartment

### + **Secure locking option**

with KEY Lock locking system (CODE/RFID Lock and other locking systems on request)

### + **Protection against corrosion**

with base that is galvanised in addition to being powder-coated

### + **Flexible range of applications**

with charging options for battery-operated BDE devices, laptops, tablets or smartphones

### + **Battery charging cabinet for electric scooters**

with additional ramp in front of the base

### + **Outstanding safety features**

CE compliant

Art. no. **98.160.010**  
Pale blue, RAL 5012



Art. no. **98.166.010**  
Pale blue, RAL 5012

### Clothes lockers

The clothes lockers are equipped with the following for each compartment: Single-leaf solid sheet door, flush-fitting, smooth surface (1 compartment lockable), 1 hat shelf, 1 clothes rack with 3 sliding coat hooks, 1 towel holder, 2 × 230 V sockets.



| <b>Cabinet width mm</b><br><b>500 mm</b> | <b>1800 mm</b><br>with base, 100 mm | Model    | Modules per compartment | Lock<br>KEY Lock | compartment width<br><b>300 mm</b> |                              |
|--|-------------------------------------|----------|-------------------------|------------------|------------------------------------|------------------------------|
|  |                                     |          |                         |                  | Art. no.                           | Art. no.                     |
|  |                                     | D/Schuko | 2 × 230V                | KEY Lock         | 2 plain<br><b>98.156.XXX</b>       | 3 plain<br><b>98.158.XXX</b> |
|  |                                     | CH       | 2 × 230V                | KEY Lock         | <b>98.155.XXX</b>                  | <b>98.157.XXX</b>            |
|  |                                     | F        | 2 × 230V                | KEY Lock         | <b>98.161.XXX</b>                  | <b>98.159.XXX</b>            |
|  |                                     | GB       | 2 × 230V                | KEY Lock         | <b>98.162.XXX</b>                  | <b>98.160.XXX</b>            |

### E-scooter cabinets

The e-scooter cabinets are equipped with the following for each compartment: single-leaf solid sheet door, flush-fitting, perforated field for additional ventilation (1 compartment lockable), 1 hat shelf, 1 clothes rack with 3 sliding coat hooks, 1 velcro holder, 2 × 230 V sockets.



| mm   | mm  | mm   | Model    | Number of compartments × compartment width (mm) | Modules per compartment | Lock     | Art. no.          |
|------|-----|------|----------|---|-------------------------|----------|-------------------|
| 1000 | 500 | 1700 | D/Schuko | 2 × 500   | 2 × 230V                | KEY Lock | <b>98.166.XXX</b> |
| 1000 | 500 | 1700 | CH       | 2 × 500   | 2 × 230V                | KEY Lock | <b>98.167.XXX</b> |
| 1000 | 500 | 1700 | F        | 2 × 500   | 2 × 230V                | KEY Lock | <b>98.168.XXX</b> |
| 1000 | 500 | 1700 | GB       | 2 × 500   | 2 × 230V                | KEY Lock | <b>98.169.XXX</b> |



**Power modules for clothes lockers and e-scooter cabinets**

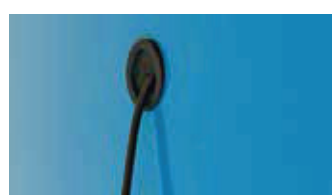

**Connecting cable**

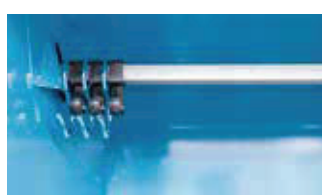

**Clothes rack**



**Hook and loop fastener for e-scooter cabinet**



**Level, horizontally configured compartments make the LISTA laptop cabinet the optimal storage solution for notebooks and similar devices.**

They also feature a particularly effective space-saving design and can be equipped with various power modules and locking solutions to tailor them more flexibly to your requirements.

- 
- + Flexible range of applications**  
with charging options for laptops, tablets and smart-phones
  - + Sophisticated ventilation**  
optimal air circulation via rear air vents
  - + Secure locking option**  
Devices are locked away at all times and are protected against unauthorised use with intelligent locking systems such as CODE/RFID locks.
  - + Protects against dirt**  
thanks to substructure with base to prevent dirt from accumulating under the cabinet
  - + Outstanding safety features**  
CE compliant





Art. no. **98.416.070**  
Ruby red, RAL 3003

W → mm   
 D ↗ mm   
 H ↑ mm   
 No. of compartments   
 Shelf dimension (W × H mm)   
 Type   
 Module per compartment   
 Art. no.

**Laptop cabinets with 10 compartments and cylinder lock**

| W   | D   | H    | No. of compartments | Shelf dimension (W × H mm) | Type   | Module per compartment | Art. no.          |
|-----|-----|------|---------------------|----------------------------|--------|------------------------|-------------------|
| 415 | 500 | 1790 | 1 × 10              | 330 × 140                  | D / PE | 1 × 230V               | <b>98.600.XXX</b> |
| 415 | 500 | 1790 | 1 × 10              | 330 × 140                  | D / PE | 2 × 230V               | <b>98.582.XXX</b> |
| 415 | 500 | 1790 | 1 × 10              | 330 × 140                  | CH     | 1 × 230V               | <b>98.597.XXX</b> |
| 415 | 500 | 1790 | 1 × 10              | 330 × 140                  | CH     | 2 × 230V               | <b>98.583.XXX</b> |
| 415 | 500 | 1790 | 1 × 10              | 330 × 140                  | F      | 1 × 230V               | <b>98.598.XXX</b> |
| 415 | 500 | 1790 | 1 × 10              | 330 × 140                  | F      | 2 × 230V               | <b>98.584.XXX</b> |
| 415 | 500 | 1790 | 1 × 10              | 330 × 140                  | GB     | 1 × 230V               | <b>98.599.XXX</b> |
| 415 | 500 | 1790 | 1 × 10              | 330 × 140                  | GB     | 2 × 230V               | <b>98.585.XXX</b> |



**Power modules for laptop cabinet**

Socket strip can be ordered with one or two 230 V sockets per compartment.



**USB adapter for sockets**

1 × USB-C connection, 3 × USB-A connection  
Overcharge, deep discharge, overload and short-circuit protection Colour: Black

Art. no. **61.257.000**



When ordering a laptop cabinet on this page with **CODE/RFID Lock**, please specify the suffix **"F"** in addition to the article number from the table (e.g. **98.600.XXX.F**)



Thanks to its high resistance to light and weathering, the LISTA e-bike charging station is ideally suited for the central supply of batteries for outdoor use. Each compartment has a power module with two fused sockets. In addition to business and public authorities, schools, universities, airports, restaurants, cafés, hotels and other public buildings can also be equipped with the e-bike charging station for outdoor use.

### + Utmost stability and convenience

thanks to welded sheet steel housing made of electrolytically galvanised sheet steel and double-walled doors with opening limiter and self-closing function

### + Well protected

thanks to high-quality polyester resin powder coating with high light and weather resistance, cabinet housing and electrical components protected against splashes (IP44 in accordance with DIN EN 60529), inclined top with front projection as rain protection

### + Perfect cable management

thanks to 230V socket with cover, FI/LS switch for each compartment, power supply via ground cable, access in base in spray water-protected distribution box (IP65), roof and left side panel removable as inspection opening (screwed), inspection opening in lower compartment incl. distributor box in base area

### + Sophisticated ventilation

thanks to integrated heat ventilation conduit and passive ventilation in each compartment

### + Outstanding safety features

CE compliant

### + Secure locking option

with security cylinder lock, coin deposit lock or cashier lock (other locking systems available on request)







Art. no. **61.200.495**  
Pale grey, RAL 7035

Art. no. **61.217.498**  
Pale grey, RAL 7035  
Pale blue, RAL 5012

Art. no. **61.218.499**  
Pale grey, RAL 7035  
Metallic grey, NCS S 6502-B



**Socket outlet**  
230V/16A with cover,  
FI/LS switch per compartment

**W** → 600 mm    **D** ↗ 500 mm    **H** ↑ 2059 / 2000 mm, with 200 mm base

|                        |                            |   |               |             |            |             |
|------------------------|----------------------------|---|---------------|-------------|------------|-------------|
| Number of compartments | Shelf dimension (W × H mm) | 🔒 | Art. no. D/PE | Art. no. CH | Art. no. F | Art. no. GB |
|------------------------|----------------------------|---|---------------|-------------|------------|-------------|

**Battery charging cabinet as e-bike charging station**

| Number of compartments | Shelf dimension (W × H mm) | Lock type         | Art. no. D/PE | Art. no. CH | Art. no. F | Art. no. GB |
|------------------------|----------------------------|-------------------|---------------|-------------|------------|-------------|
| 1 × 4                  | 370 × 370                  | Cylinder lock     | 61.200.XXX    | 61.217.XXX  | 61.218.XXX | on request  |
|                        |                            | Coin deposit lock | 61.219.XXX    | 61.220.XXX  | 61.221.XXX | on request  |
|                        |                            | Cashier lock      | 61.222.XXX    | 61.223.XXX  | 61.224.XXX | on request  |

**Accessories for coin deposit lock and cashier lock**

| Accessories   | sales unit | Art. no.   |
|---|------------|------------|
| <b>Armband</b> , nylon, colour: blue                                  | 10 items   | 97.608.000 |
| <b>Numbered set</b> no. variable                                      | 50 tiles   | 11.696.000 |
| <b>Promax removal key</b> , new system                                | 1 key      | 96.340.000 |
| <b>Cash box key</b> for cashier lock for emptying coin collecting box | 1 key      | 98.179.000 |



**Cylinder lock**  
with 3 keys and key security card



**Coin deposit lock**  
with door plate (without IP × 4 protection)

**i Choice of colour**

The LISTA battery-charging cabinet for outdoor use is available in the following three colours (high-quality polyester resin powder paint). When ordering, please use the desired three-digit colour code (instead of XXX).



**.495** Pale grey  
RAL 7035

**.498** Pale grey  
RAL 7035  
Pale blue  
RAL 5012

**.499** Pale grey  
RAL 7035  
Metallic grey  
NCS S 6502-B

➤ Please contact us for more information



**Cashier lock**  
mechanical (without IP × 4 protection)



**LISTA environmental and oil cabinets are suitable for the safe and standard storage of water-hazardous substances in water hazard class (WGK) 1–3.** Liquids that are required in the daily work flow are stored safely in LISTA oil cabinets. Pull-out shelves hold the liquid canisters. Drops of liquid are collected in the drip tray.

- 
- + Maximum stability**  
with housing load capacity of up to 500 kg
  - + High load capacities**  
Drip trays with a load capacity of up to 100 kg and canister shelves up to 200 kg
  - + Can be adapted to new storage items at any time**  
by inserting or converting drip trays and canister shelves in 25-mm increments as required
  - + Individual equipment options**  
with drip trays, canister shelves, base trays, canisters and drawers
  - + Safe and orderly storage**  
with drip trays welded to form a liquid-tight seal according to Section 19 of the Water Resources Act/German directive on steel trays (StawaR).
  - + Secure locking**  
with solid-sheet doors (flush-fitting, folded from one piece) and selectable locking systems
  - + Sophisticated ventilation**  
with perforated field at the top and bottom of environmental lockers



**Oil cabinet**  
Art. no. **71.461.010**  
Light blue, RAL 5012



**Environmental cabinet**  
Art. no. **60.474.030**  
Reseda green, RAL 6011

**Oil cabinets**

The cabinets are fitted with: chromium steel drip trays, 2 mm thick, welded to form a liquid-tight seal according to Section 19 of the Water Resources Act/German directive on steel trays (StawaR), 40-litre capacity, canister shelves (painted grey), NCS 4502-B, canister made of HDPE plastic with outlet valve (glossy chrome finish). Solid-sheet hinged doors folded from one piece, with fulcrum pins, 235-degree opening angle.

**W** → 717 mm    **D** ↗ 753 mm    **H** ↑ 1450 mm



**Cabinets with 2 solid sheet doors**

| Equipment  | kg  | Door storage | Lock     | Art. no.          |
|--|-----|--------------|----------|-------------------|
| 2 canister shelves<br>8 canisters, 25 l each<br>1 drip tray<br>Tank dimensions:<br>651×620×100 mm (W×D×H)                            | 200 | Fulcrum pin  | KEY Lock | <b>71.460.XXX</b> |
| 3 canister shelves<br>10 canisters, 10 l each<br>4 canisters, 25 l each<br>1 drip tray<br>Tank dimensions:<br>651×620×100 mm (W×D×H) | 200 | Fulcrum pin  | KEY Lock | <b>71.461.XXX</b> |



**i Canister with outlet tap**

Fitted with screw cap. Filter in the filler neck. Outlet tap, glossy chrome finish with seal. Specification: HDPE plastic, transparent.

| Width  | Depth  | Height | Volumetric capacity | Art. no.          |
|--------|--------|--------|---------------------|-------------------|
| 120 mm | 440 mm | 270 mm | 10 l                | <b>14.990.000</b> |
| 150 mm | 440 mm | 490 mm | 25 l                | <b>14.991.000</b> |

**Environmental cabinets**

The cabinets are fitted with: galvanised drip trays, 3 mm thick, welded to form a liquid-tight seal according to Section 19 of the Water Resources Act/German directive on steel trays (StawaR), 20-litre capacity. Solid-sheet hinged doors folded from one piece, with hinges, 115-degree opening angle.

**W** → 1000 mm    **D** ↗ 500 mm    **H** ↑ 1950 mm



**Cabinet with 2 solid sheet doors**

| Equipment   | kg  | Door storage | Lock     | Art. no.          |
|---|-----|--------------|----------|-------------------|
| 4 drip trays<br>Tank dimensions:<br>982×445×70 mm (W×D×H) | 100 | Hinge        | KEY Lock | <b>60.474.XXX</b> |



**Observe legal regulations and directives**

The canisters may only be filled with acid- and lye-free liquids (no abrasive media), oils and grease with a flame point above 55° Celsius. Maximum ambient temperature 40° Celsius. Please call us for special applications and further information.

**i Note:**  
Not suitable for storage of flammable materials



**Canister shelf**

The canister shelf has a handle on the left and right and a centre lip. It is only 27 E (451 mm) deep so there is enough room in the front area for the canister tap.



**Built-under drainage tray for oil cabinet**

The built-under drainage tray of the oil cabinet has a leak-proof welded construction according to the Water Resources Act Sec. 19/StawaR (German directive on steel trays) and has a test certificate. It has a volumetric capacity of 40 l. Art. no. **14.995.000**



**Drip trays**

The drip trays feature a leak-proof welded construction according to StawaR (German directive on steel trays) and have a test certificate.



## Vi kan skreddersy innredningen til ditt behov.

Vi står disponible til å bistå i deres prosjekter.

\*3D tegninger.

\*Oppmålinger.

\*Kartlegging av behov.

\*Montasje.

Ta gjerne kontakt med oss om du har et behov som ikke finnes i katalogen.



Lista ble grunnlagt i 1945

Hovedkontoret ligger i Sveits.



Produksjonen foregår i Sveits og Tyskland.



### Kontaktinfo:

Ing Yngve Ege AS

Postadresse:  
Postboks 1 Sentrum  
0101 Oslo

Besøksadresse:  
Ryenstubben 5  
0679 Oslo

Tel: 23 24 10 00  
Fax: 23 24 10 01

[ege@ege.no](mailto:ege@ege.no)

Produktansvarlig.

Navn:

Telefon:

Epost: